



DORFIX[®]

Architectural Hardware

THE FIDELITY BUILT OVER DECADES
Product Catalogue 2023

Global Leaders in Manufacturing Premium Quality Hardware Products



- ◆ USA
- ◆ CANADA
- ◆ INDIA
- ◆ NEPAL
- ◆ U.A.E.
- ◆ MEXICO
- ◆ BANGLADESH
- ◆ SRI LANKA



Brands That Trust Our Products





Company Profile



DORFIX
Architectural Hardware

DORFIX Architectural Hardware Quality products are always up to date and make big efforts to deliver the right quality at the right time. We are located in the heart of Delhi with skilled worker to produce the most reliable product and efficient delivery.

We understand that buyers are value-conscious. Thus we operate efficiently, to maintain the lowest overhead, and ensure competitive price.

We emphasize on providing the best quality products to our customers that can be assured through our infinite quality control efforts. To satisfy our clientele, we always emphasize on the quality of the products hence subject the manufactured products to stringent quality checks. Quality raw materials make the product range the foremost choice in the market.

Further more there attributes of our ethical business policy quality product, timely delivery and competitive price have helped us in forming in clientele.



DORFIX
Architectural Hardware

CONTENTS

01-04	Floor Spring and Combo Set	40-43	Spider Fitting
05	Hydraulic Patch Fitting and Combo Set	44	Articulated Routels
06-10	Patch Fittings	45	Fin Plates & Splice Plates
11-12	Shower Hinges	46	Door Closer
13-14	Glass Connectors	47-49	Locks Without Cutout
15-16	PVC Profiles	50	Biometric Smarter Series Locks
17-19	Shower Knight Head Accessories	51-54	Door Handles with Lock and Door Handles
20	Door Knobs and Shower Handles	55	Automatic Sliding Sensor Doors
21	Shower Sliding System (DFSL-11ED)	56	Shelf Support Buttons & Brackets
22	Soft Sliding System	57	Mirror Accessories
23-25	Sliding System and Accessories	58	Bracket Shelf Holder
26	Frameless Center Sliding Folding System	59	Glass Runners and / Glass Lifter / Screws & Bolts
27-28	Glass Sliding Folding System	60-62	Glass Railing Accessories
29	Sliding Door System (DFSL-33A)	63	Kitchen and Wardrobe Frame Profile
30	Manet Sliding System and Frameless Telescopic System	64-65	Aluminium Railing
31	SYSr Sliding System	66	Silicon Sealent and Silicone Gun
32	Canopy Fitting and Point Fixed Glass Connectors	66	Double Sided Structural Glazing Tape
33-34	Telescopic and Synchronized Sliding System	66	Adhesive
35-37	Slim Profile Series and Accessories		
38	Automatic Swing Door		
39	Wooden Sliding Folding System		



AN ISO 9001 : 2015 CERTIFIED CO.



OUR POPULAR FLOOR SPRING COMBO SET SERIES

For warranty information, please visit us at:
www.dorfixhardware.com/warranty



DFFS-74A
Single Spring Floor Hinge



DFFS-84A
Double Spring Floor Hinge

Water Resistant Seal
Inside of Cover Plate



Water Resistant Seal
Inside of Cover Plate



DFFP-20
Bottom Patch



DFFP-10
Top Patch



DFPL-90
Corner Patch Lock



DFFS-ACC-GDP
Pivot



DFDH-55
H Handle

Specifications:

- Floor Spring with the Most Advanced & the Strongest German Spring for Smooth door operation; equipped with the Strongest in class (1.2mm) Rustproof SS 304 cover plate.
- Patch Fittings Cover Plates Manufactured using Strong (1.0mm) Rustproof SS 304 raw material.
- Lock equipped with Stronger Cylinder made of Brass featuring 4 Computerized Anti-Theft Brass keys.
- Embedded Brass threading inside the body for uninterrupted installation and longer life of patch fittings.

The Strongest, Robustest & Most Reliable Floor Spring

German
spring
www.dorfix.com

TESTED TO
1 Million
CYCLES

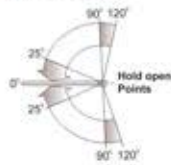

Specification :
General design, suitable for left or right hand to open the door in single and both sides.
Used low temp. hydraulic oil for any climate operation and constant lubrication.
Suitable for wooden and toughened glass doors.
Suitable for door weight Up to 85-120kgs.
Closing force 25nm.
Suitable for maximum wide door leaf 1300x2400mm.
Tested to 1 Million Cycles.
Opening angle 90° / 115°
304 SS Plate

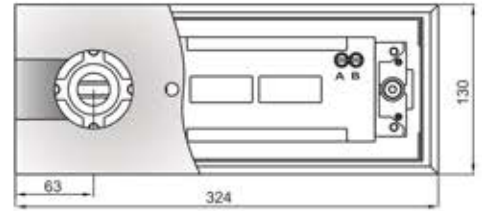

DFFS-84 A
Double Spring Floor Hinge



DFFS-84 A BM
Double Spring Floor Hinge



DFFS-84 A G
Double Spring Floor Hinge



DFFS-84 A RG
Double Spring Floor Hinge

Combo Set DFFS-84 A SS



DFFS-84 A
Double Spring Floor Hinge



DFPF-10
Top Patch



DFPF-20
Bottom Patch



DFPL-90
Corner Patch Lock



DFFS-ACC-GDP
Pivot



DFDH-55
H Handle

Black Matt



DFFS-84 A BM
Double Spring Floor Hinge



DFPF-10 BM
Top Patch



DFPF-20 BM
Bottom Patch



DFPL-90 BM
Corner Patch Lock



DFFS-ACC-GDP BM
Pivot



DFDH-55 BM
H Handle

DFPL-90
Corner Patch Lock with Strike Plate

Gold



DFFS-84 A G
Double Spring Floor Hinge



DFPF-10 G
Top Patch



DFPF-20 G
Bottom Patch



DFPL-90 G
Corner Patch Lock



DFFS-ACC-GDP G
Pivot



DFDH-55 G
H Handle

Rose Gold



DFFS-84 A RG
Double Spring Floor Hinge



DFPF-10 RG
Top Patch



DFPF-20 RG
Bottom Patch



DFPL-90 RG
Corner Patch Lock



DFFS-ACC-GDP RG
Pivot

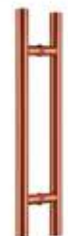

DFDH-55 RG
H Handle

TESTED TO
1 Million
CYCLES

Specification :
General design, suitable for left or right hand to open the door in single and both sides.
Used low temp. hydraulic oil for any climate operation and constant lubrication.
Suitable for wooden and toughened glass doors.
Suitable for door weight from 60-80kgs.
Closing force 25nm.
Suitable for maximum wide door leaf 1100x2400mm.
Tested to 1 Million Cycles.
Opening angle 90° / 115°
304 SS Plate

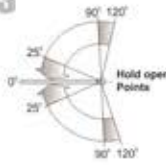
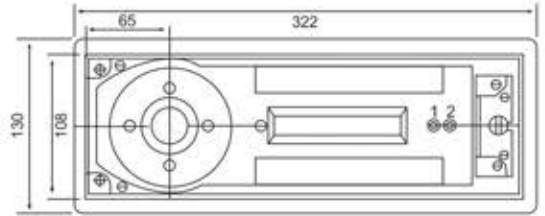

DFFS-74 A
Double Spring Floor Hinge



DFFS-74 A BM
Double Spring Floor Hinge



DFFS-74 A G
Double Spring Floor Hinge



DFFS-74 A RG
Double Spring Floor Hinge

Combo Set DFFS-74 A SS



DFFS-74 A
Double Spring Floor Hinge



DFPF-10
Top Patch



DFPF-20
Bottom Patch



DFPL-90
Corner Patch Lock



DFFS-ACC-GDP
Pivot



DFDH-55
H Handle

Black Matt



DFFS-74 A BM
Double Spring Floor Hinge



DFPF-10 BM
Top Patch



DFPF-20 BM
Bottom Patch



DFPL-90 B
Corner Patch Lock



DFFS-ACC-GDP BM
Pivot



DFDH-55 BM
H Handle

Gold



DFFS-74 A G
Double Spring Floor Hinge



DFPF-10 G
Top Patch



DFPF-20 G
Bottom Patch



DFPL-90 G
Corner Patch Lock



DFFS-ACC-GDP G
Pivot



DFDH-55 G
H Handle

Rose Gold



DFFS-74 A RG
Double Spring Floor Hinge



DFPF-10 RG
Top Patch



DFPF-20 RG
Bottom Patch



DFPL-90 RG
Corner Patch Lock



DFFS-ACC-GDP RG
Pivot



DFDH-55 RG
H Handle



DFFS-6600
Single Spring Floor Hinge

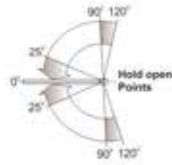

Specification :
General design, suitable for left or right hand to open the door in single and both sides.
Used low temp. hydraulic oil for any climate operation and constant lubrication.
Suitable for wooden and toughened glass doors.
Suitable for door weight Up to 55kgs.
Closing force 19nm.
Suitable for maximum wide door leaf 900x2100mm.
Tested to 600000 Cycles.
Opening angle 90° / 115°
304 SS Plate

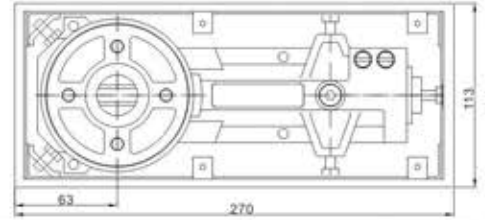

E Series



DFFS-8400
Double Spring Floor Hinge

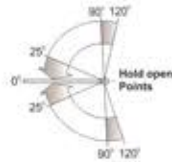

Specification :
General design, suitable for left or right hand to open the door in single and both sides.
Used low temp. hydraulic oil for any climate operation and constant lubrication.
Suitable for wooden and toughened glass doors.
Suitable for door weight from 90-120kgs.
Closing force 19nm.
Suitable for maximum wide door leaf 1100x2200mm.
Tested to 600000 Cycles.
Opening angle 90° / 115°
304 SS Plate

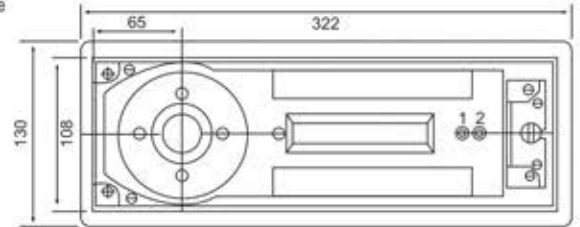

DFFS-9400
Double Spring Floor Hinge

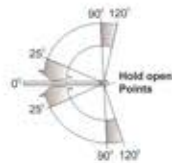

Specification :
General design, suitable for left or right hand to open the door in single and both sides.
Used low temp. hydraulic oil for any climate operation and constant lubrication.
Suitable for wooden and toughened glass doors.
Suitable for door weight from 120-150kgs.
Closing force 25nm.
Suitable for maximum wide door leaf 1300x2400mm.
Tested to 600000 Cycles.
Opening angle 90° / 115°
304 SS Plate

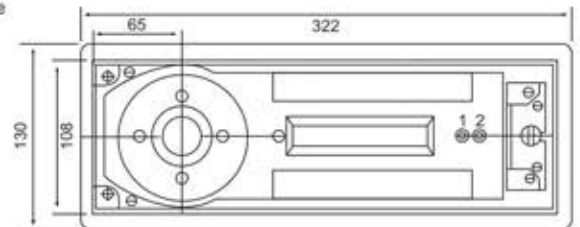

DFFS-10400
Double Spring Floor Hinge

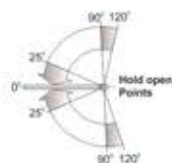

Specification :
General design, suitable for left or right hand to open the door in single and both sides.
Used low temp. hydraulic oil for any climate operation and constant lubrication.
Suitable for wooden and toughened glass doors.
Suitable for door weight from 150-200kgs.
Closing force 19nm.
Suitable for maximum wide door leaf 1300x2400mm.
Tested to 600000 Cycles.
Opening angle 90° / 115°
304 SS Plate

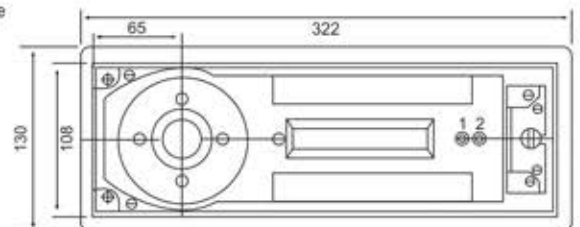



TAIWAN PRODUCTION LINE

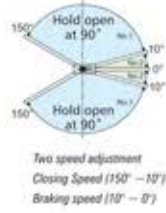
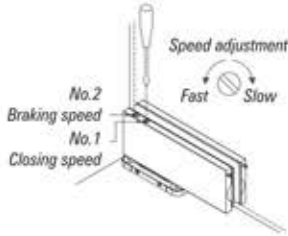

Specification
 Suitable door weight : Max 100kg
 Suitable door width : 1050mm
 Suitable door thickness : 8~13mm
 Ambient temperature : -20°C~+50°C
 Quick and easy installation

Max. opening angle: 150° for left and right opening (double action)
 Hold open at 90°

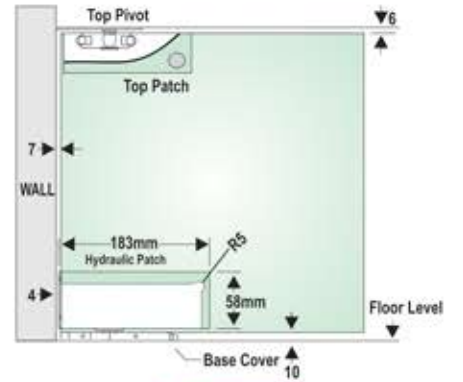

DFHPF-100 Hydraulic Floor Spring



DFHPF-100 BM Hydraulic Floor Spring



DFHPF-100 G Hydraulic Floor Spring



DFHPF-100 RG Hydraulic Floor Spring

DFHPF-100 Combo Set



DFHPF-100 Hydraulic Floor Spring



DFPPF-10 Top Patch



DFSS-ACC-GDP Pivot



DFDH-55 H Handle



DFHPF-100 BM Hydraulic Floor Spring



DFPPF-10 BM Top Patch



DFSS-ACC-GDP BM Pivot



DFDH-55 BM H Handle



DFHPF-100 G Hydraulic Floor Spring



DFPPF-10 G Top Patch



DFSS-ACC-GDP G Pivot



DFDH-55 G H Handle



DFHPF-100 RG Hydraulic Floor Spring



DFPPF-10 RG Top Patch



DFSS-ACC-GDP RG Pivot



DFDH-55 RG H Handle



DFPF-10
Top Patch

Specification

Finish : Satin stainless steel
Pivot point of 55 / 65mm
Patch Fitting Cover Plates Manufactured using Strong (1.0mm) Rustproof SS 304 Raw Material. High quality tempered precision screws are used to ensure solid gripping
Embedded Brass Threading inside the Body for Uninterrupted installation and Longer Life of Patch Fitting.

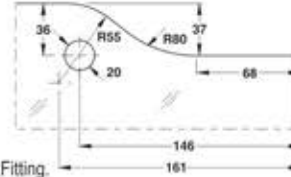

DFPF-10 BM
Top Patch



DFPF-10 G
Top Patch



DFPF-10 RG
Top Patch



DFPF-20
Bottom Patch

Specification

Finish : Satin stainless steel
Suitable for Kiff Floor Hinge or any other reputed manufacturer
Pivot point of 55 / 65mm
Patch Fitting Cover Plates Manufactured using Strong (1.0mm) Rustproof SS 304 Raw Material. High quality tempered precision screws are used to ensure solid gripping
Embedded Brass Threading inside the Body for Uninterrupted installation and Longer Life of Patch Fitting.

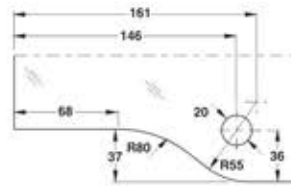

DFPF-20 BM
Bottom Patch



DFPF-20 G
Bottom Patch



DFPF-20 RG
Bottom Patch



DFPF-50
Wall Mounted Over Panel
Patch with Pivot (Over Panel)

Specification

Finish : Satin stainless steel
Suitable to secure over panel with the wall by pivot pin of 15mm dia
Pivot point of 55/65mm
Patch Fitting Cover Plates Manufactured using Strong (1.0mm) Rustproof SS 304 Raw Material. High quality tempered precision screws are used to ensure solid gripping
Embedded Brass Threading inside the Body for Uninterrupted installation and Longer Life of Patch Fitting.

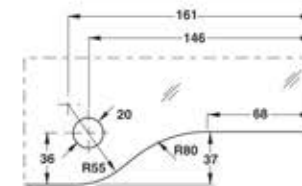

DFPF-50 BM
Wall Mounted Over Panel
Patch with Pivot (Over Panel)



DFPF-50 G
Wall Mounted Over Panel
Patch with Pivot (Over Panel)



DFPF-50 RG
Wall Mounted Over Panel
Patch with Pivot (Over Panel)



DFPF-40
Over Panel Side Panel Connecting
Patch with Pivot (Big L)

Specification

Finish : Satin stainless steel
Suitable for connecting over panel & side panel
Pivot point of 55 / 65mm
Patch Fitting Cover Plates Manufactured using Strong (1.0mm) Rustproof SS 304 Raw Material. High quality tempered precision screws are used to ensure solid gripping
Embedded Brass Threading inside the Body for Uninterrupted installation and Longer Life of Patch Fitting.

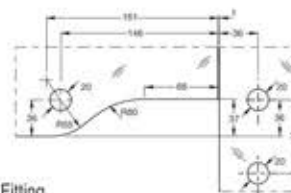

DFPF-40 BM
Over Panel Side Panel Connecting
Patch with Pivot (Big L)



DFPF-40 G
Over Panel Side Panel Connecting
Patch with Pivot (Big L)



DFPF-40 RG
Over Panel Side Panel Connecting
Patch with Pivot (Big L)



DFPL-90
Corner Patch Lock with Strike Plate

Specification

Finish : Satin stainless steel Suitable to lock swing doors.
With a euro profile cylinder and strike plate
With 4 high Security computerized keys
Single Throw Rectangular Bolt with 15mm Projection
Patch Fitting Cover Plates Manufactured using
Strong (1.0mm) Rustproof **SS 304** Raw Material.
High quality tempered precision screws are
used to ensure solid gripping
Embedded Brass Threading inside the Body for
Uninterrupted installation and Longer Life of Patch Fitting.

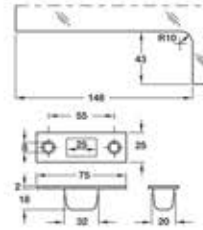

DFPL-90 BM
Corner Patch Lock with Strike Plate



DFPL-90 G
Corner Patch Lock with Strike Plate



DFPL-90 RG
Corner Patch Lock with Strike Plate



DFPF-610
Over Panel Side Panel Patch Connector
(Small L)

Specification

Finish : Satin stainless steel
Suitable for fixing over panel & side panel at the
opening top corner of the door
Corner small L Patch
Patch Fitting Cover Plates Manufactured using
Strong (1.0mm) Rustproof **SS 304** Raw Material.
High quality tempered precision screws are
used to ensure solid gripping
Embedded Brass Threading inside the Body for
Uninterrupted installation and Longer Life of Patch Fitting.

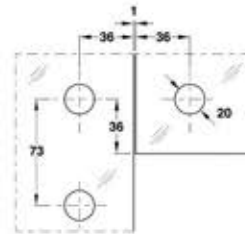

DFPF-610 BM
Over Panel Side Panel
Patch Connector (Small L)



DFPF-610 G
Over Panel Side Panel
Patch Connector (Small L)



DFPF-610 RG
Over Panel Side Panel
Patch Connector (Small L)



DFPF-640
Wall to Glass Connecting Patch

Specification

Finish : Satin stainless steel
Suitable for fixing glass with ceiling & wall
For fixing with fixed structure
Patch Fitting Cover Plates Manufactured using
Strong (1.0mm) Rustproof **SS 304** Raw Material.
High quality tempered precision screws are
used to ensure solid gripping
Embedded Brass Threading inside the Body for
Uninterrupted installation and Longer Life of Patch Fitting.

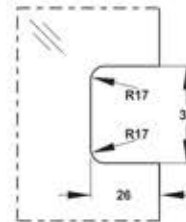

DFPF-640 RG
Wall to Glass Connecting Patch



DFPF-640 G
Wall to Glass Connecting Patch



DFPF-640 RG
Wall to Glass Connecting Patch



DFPF-650
Glass to Glass Connecting Patch with Wall/Ceiling

Specification

Finish : Satin stainless steel
Suitable for fixing two glass together with
ceiling, floor & wall
Patch Fitting Cover Plates Manufactured using
Strong (1.0mm) Rustproof **SS 304** Raw Material.
High quality tempered precision screws are
used to ensure solid gripping
Embedded Brass Threading inside the Body for
Uninterrupted installation and Longer Life of Patch Fitting.

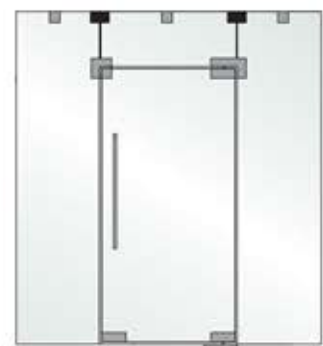
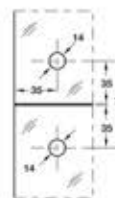

DFPF-650 BM
Glass to Glass Connecting
Patch with Wall/Ceiling



DFPF-650 G
Glass to Glass Connecting
Patch with Wall/Ceiling



DFPF-650 RG
Glass to Glass Connecting
Patch with Wall/Ceiling



DFPL-2A
Centre Patch Lock

Specification
Finish : Satin stainless steel Suitable to Lock swing doors.
Can also be use to lock doors from center.
With a euro profile cylinder and strike plate
Single Throw Rectangular Bolt with 15mm Projection
Patch Fitting Cover Plates Manufactured using
Strong (1.0mm) Rustproof **SS 304** Raw Material.
High quality tempered precision screws are
used to ensure solid gripping
Embedded Brass Threading inside the Body for
Uninterrupted installation and Longer Life of Patch Fitting.

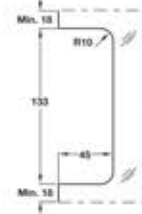

DFPL-2B
Centre Lock Strike Box

Specification
Finish : Satin stainless steel
Suitable to Lock double doors.
Strike box for **DFPL-2 A**
Patch Fitting Cover Plates Manufactured using
Strong (1.0mm) Rustproof **SS 304** Raw Material.
High quality tempered precision screws are
used to ensure solid gripping
Embedded Brass Threading inside the Body for
Uninterrupted installation and Longer Life of Patch Fitting.

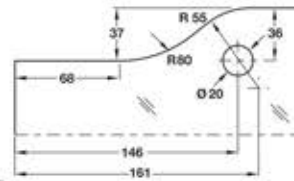

DFPL-2B
Centre Lock Strike Box



DFPL-2B
Centre Lock Strike Box



DFPL-2B
Centre Lock Strike Box



DFFS-ACC-GDP
Top Pivot for Patch Fittings Doors

Specification
Finish : Satin stainless steel
Wear Resistant **Stainless Steel 304** Pivot Pin.
Top Pivot with 15mm dia pin.
Pivot held in Overhead Structure and used with Top Patch

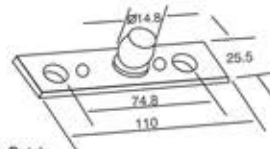

DFFS-ACC-GDP BM
Top Pivot for Patch Fittings Doors



DFFS-ACC-GDP G
Top Pivot for Patch Fittings Doors



DFFS-ACC-GDP RG
Top Pivot for Patch Fittings Doors



DFPL-3A
Latch Lock

Specification
Finish : Satin stainless steel (SSS)
Suitable to lock swing sliding & sliding doors.
Can also be use to lock the door from center/top
Thumb turn lock with single throw
Patch Fitting Cover Plates Manufactured using
Strong (1.0mm) Rustproof **SS 304** Raw Material.
High quality tempered precision screws are
used to ensure solid gripping
Embedded Brass Threading inside the Body for
Uninterrupted installation and Longer Life of Patch Fitting.



DFPL-3B
Strike Box

Specification
Finish : Satin stainless steel
Suitable for fixing glass with ceiling, floor & wall
For fixing with fixed structure
Patch Fitting Cover Plates Manufactured using
Strong (1.0mm) Rustproof **SS 304** Raw Material.
High quality tempered precision screws are
used to ensure solid gripping
Embedded Brass Threading inside the Body for
Uninterrupted installation and Longer Life of Patch Fitting.

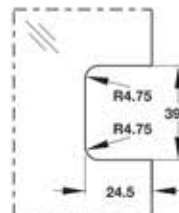

DFPF-41R
Over Panel Side Panel Connector with Fin
(Right)

Specification
Finish : Satin stainless steel
Suitable for fixing over panel & side panel along with fin
Over panel side panel with fin inside
Patch Fitting Cover Plates Manufactured using
Strong (1.0mm) Rustproof **SS 304** Raw Material.
High quality tempered precision screws are
used to ensure solid gripping
Embedded Brass Threading inside the Body for
Uninterrupted installation and Longer Life of Patch Fitting.

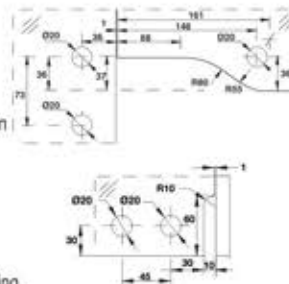



DFPF-41L

Over Panel Side Panel Connector with Fin (Left)

Specification

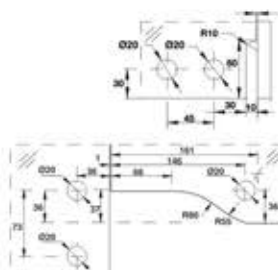
Finish : Satin stainless steel
 Suitable for fixing over panel & side panel along with fin
 Over panel side panel with fin inside
 Patch Fitting Cover Plates Manufactured using
 Strong (1.0mm) Rustproof **SS 304** Raw Material.
 High quality tempered precision screws are
 used to ensure solid gripping
 Embedded Brass Threading inside the Body for
 Uninterrupted installation and Longer Life of Patch Fitting.

DFPF-610LR

Triple Glass Patch Connector with Fin (Left/Right)

Specification

Finish : Satin stainless steel
 Suitable for fixing over panel & side along with fin
 to be used at the opening top corner of the door.
 L / R shape from outside with fin inside
 Patch Fitting Cover Plates Manufactured using
 Strong (1.0mm) Rustproof **SS 304** Raw Material.
 High quality tempered precision screws are
 used to ensure solid gripping
 Embedded Brass Threading inside the Body for
 Uninterrupted installation and Longer Life of Patch Fitting.

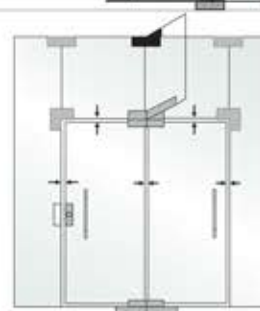
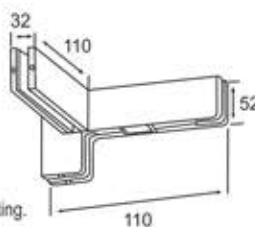
DFPF-650

Glass to Glass Connecting Patch with Wall/Ceiling

Specification

Finish : Satin stainless steel
 Suitable for fixing two glass together with ceiling, floor & wall
 Patch Fitting Cover Plates Manufactured using
 Strong (1.0mm) Rustproof **SS 304** Raw Material.
 High quality tempered precision screws are
 used to ensure solid gripping
 Embedded Brass Threading inside the Body for
 Uninterrupted installation and Longer Life of Patch Fitting.

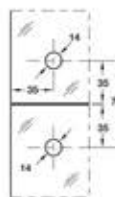
DFPF-51

Double Over Panel Patch with Fin

Specification

Finish : Satin stainless steel
 Suitable for back to back doors with pivot along with fin
 Over panel with pivot for back to back doors
 Patch Fitting Cover Plates Manufactured using
 Strong (1.0mm) Rustproof **SS 304** Raw Material.
 High quality tempered precision screws are
 used to ensure solid gripping
 Embedded Brass Threading inside the Body for
 Uninterrupted installation and Longer Life of Patch Fitting.

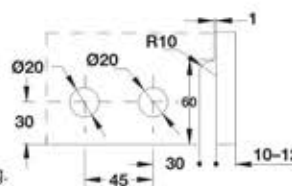
DFPF-51 D

Double Over Panel Patch

Specification

Finish : Satin stainless steel
 Suitable for fixing over panel & side along with fin to be used at the
 opening top corner of the door.
 L shape from outside with fin inside
 Patch Fitting Cover Plates Manufactured using
 Strong (1.0mm) Rustproof **SS 304** Raw Material.
 High quality tempered precision screws are
 used to ensure solid gripping
 Embedded Brass Threading inside the Body for
 Uninterrupted installation and Longer Life of Patch Fitting.

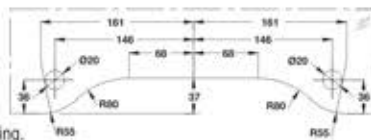
DFPL-610ST

Over Panel Side Panel Patch Connector with Stopper

Specification

Finish : Satin stainless steel
 Suitable for fixing over panel & side panel at the
 opening top corner of the door
 also restricts one side opening of the door
 Square look from one side & L shape from another side
 Patch Fitting Cover Plates Manufactured using
 Strong (1.0mm) Rustproof **SS 304** Raw Material.
 Cover fixed with Allen screw to ensure that the
 cover remained secure in its place
 Embedded Brass Threading inside the Body for
 Uninterrupted installation and Longer Life of Patch Fitting.

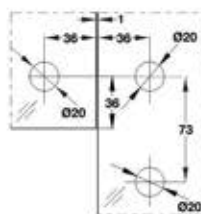
DFPF-620

Quadruple Patch

Specification

Finish : Satin stainless steel
 Suitable for fixing maximum four no's of fixed glass
 For fixing maximum up to four glasses
 Patch Fitting Cover Plates Manufactured using
 Strong (1.0mm) Rustproof **SS 304** Raw Material.
 High quality tempered precision screws are
 used to ensure solid gripping
 Embedded Brass Threading inside the Body for
 Uninterrupted installation and Longer Life of Patch Fitting.

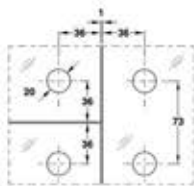



DFPF-620F
Quadruple Patch with Fin

Specification

Finish : Satin stainless steel
Suitable for fixing maximum four fixed glasses with fin inside.
For fixing maximum four glasses in line with fin inside
Patch Fitting Cover Plates Manufactured using
Strong (1.0mm) Rustproof **SS 304** Raw Material.
High quality tempered precision screws are
used to ensure solid gripping
Embedded Brass Threading inside the Body for
Uninterrupted installation and Longer Life of Patch Fitting.

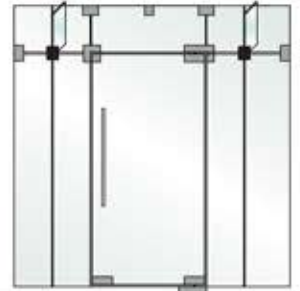
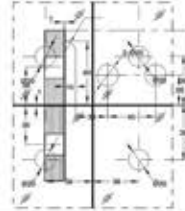

DFPF-650F
Connector with Fin

Specification

Finish : Satin stainless steel
Suitable for fixing two fixed glasses in line with fin inside.
For fixing two glasses in line with fin inside
Patch Fitting Cover Plates Manufactured using
Strong (1.0mm) Rustproof **SS 304** Raw Material.
High quality tempered precision screws are
used to ensure solid gripping
Embedded Brass Threading inside the Body for
Uninterrupted installation and Longer Life of Patch Fitting.

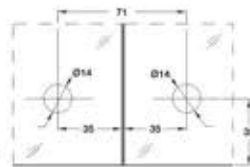

View from outside with Fin on the inside



DFPF-660
Double Glass Connecting Patch

Specification

Finish : Satin stainless steel
Suitable for fixing two fixed glasses.
Patch Fitting Cover Plates Manufactured using
Strong (1.0mm) Rustproof **SS 304** Raw Material.
High quality tempered precision screws are
used to ensure solid gripping
Embedded Brass Threading inside the Body for
Uninterrupted installation and Longer Life of Patch Fitting.

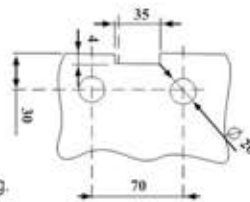

DFFS-MFH
Mini Floor Hinge



Specification

With stainless steel Cover
Finish : Satin stainless steel
Can be used for Small Doors with Bottom Patch.

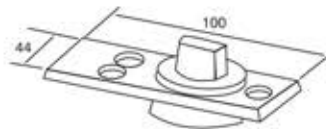

DFFS-ACC-TP/BP
Top Pivot/Bottom Pivot
for Wooden/Aluminium Doors

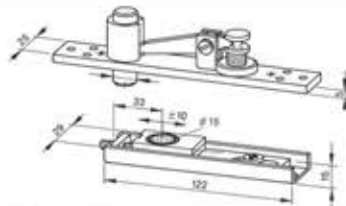

Specification

Material : Brass
Arm Pivot Set For Wooden & Aluminium Doors



DFGDS
Glass Door Stopper





DFSH-11 H/P
Wall to Glass 90° Off Set Hinge

Material : SS 304 / ED
Door Thickness : 8mm-12mm
Weight Cap. : 45kg
Finish : Matt & Chrome Plated



DFSH-11 H/P BM
Wall to Glass 90° Off Set Hinge



DFSH-11 H/P G
Wall to Glass 90° Off Set Hinge



DFSH-11 H/P RG
Wall to Glass 90° Off Set Hinge

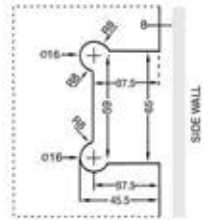

DFSH-11
Wall to Glass 90° Hinge

Material : SS 304 / ED
Door Thickness : 8mm-12mm
Weight Cap. : 45kg
Finish : Matt & Chrome Plated



DFSH-11 BM
Wall to Glass 90° Hinge



DFSH-11 G
Wall to Glass 90° Hinge



DFSH-11 RG
Wall to Glass 90° Hinge

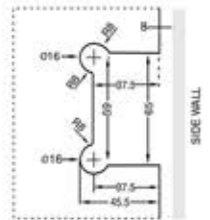

DFSH-22
Glass to Glass 180° Hinge

Material : SS 304 / ED
Door Thickness : 8mm-12mm
Weight Cap. : 45kg
Finish : Matt & Chrome Plated



DFSH-22 BM
Glass to Glass 180° Hinge



DFSH-22 G
Glass to Glass 180° Hinge



DFSH-22 RG
Glass to Glass 180° Hinge

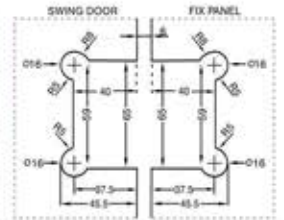

DFSH-33
Glass to Glass 135° Hinge

Material : SS 304 / ED
Door Thickness : 8mm-12mm
Weight Cap. : 45kg
Finish : Matt & Chrome Plated



DFSH-33 BM
Glass to Glass 135° Hinge



DFSH-33 G
Glass to Glass 135° Hinge



DFSH-33 RG
Glass to Glass 135° Hinge

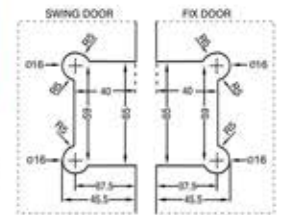

DFSH-44
Glass to Glass 90° Hinge

Material : SS 304 / ED
Door Thickness : 8mm-12mm
Weight Cap. : 45kg
Finish : Matt & Chrome Plated



DFSH-44 BM
Glass to Glass 90° Hinge



DFSH-44
Glass to Glass 90° Hinge



DFSH-44 RG
Glass to Glass 90° Hinge

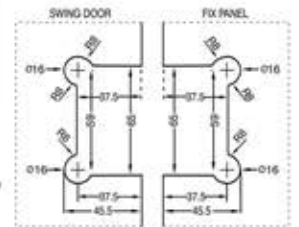

DFSH-55
Wall to Glass 90° Fix Bracket

Material : SS 304 / ED
Door Thickness : 8mm-12mm
Weight Cap. : 45kg
Finish : Matt & Chrome Plated



DFSH-55 BM
Wall to Glass 90° Fix Bracke



DFSH-55 G
Wall to Glass 90° Fix Bracke



DFSH-55 RG
Wall to Glass 90° Fix Bracke

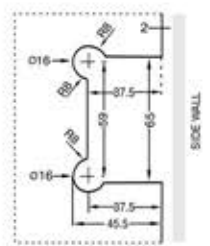

DFSH-6
Double Glass Hinge Joint with Fixed Glass

Specification
Self closing function for both doors when stays at 30° approx.
Material : SS 304
Door Thickness : 8mm-12mm
Weight Capacity : 45kg
Finish : Satin Nikle & Chrome Plated
With Gasket to Prevent Glass From Damage
Secure Holding with Glass

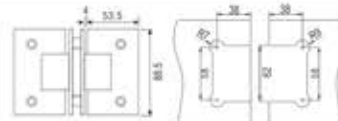

DFSH-6 BM



DFSH-6 g



DFSH-6 RG



DFSH-7
Pivot Hinge for Floor/Ceiling

Specification
Material : SS 304
Door Thickness : 8mm-12mm
Weight Capacity : 45kg
Finish : Matt & Chrome Plated
With Gasket to Prevent Glass From Damage
Secure Holding with Glass



DFSH-1 H/P
Wall to Glass 90° Off Set Hinge

Material : SS 304
Door Thickness : 8mm-12mm
Weight Cap. : 45kg
Finish : Matt & Chrome Plated



DFSH-111 H/P
Wall to Glass 90° Off Set Hinge

Material : Forged Brass
Door Thickness : 8mm-12mm
Weight Cap. : 45kg
Finish : Matt & Chrome Plated

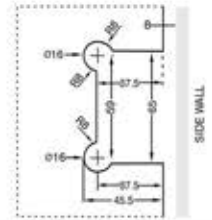

DFSH-1
Wall to Glass 90° Hinge

Material : SS 304
Door Thickness : 8mm-12mm
Weight Cap. : 45kg
Finish : Matt & Chrome Plated



DFSH-111
Wall to Glass 90° Hinge

Material : Forged Brass
Door Thickness : 8mm-12mm
Weight Cap. : 45kg
Finish : Matt & Chrome Plated

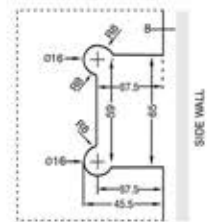

DFSH-2
Glass to Glass 180° Hinge

Material : SS 304
Door Thickness : 8mm-12mm
Weight Cap. : 45kg
Finish : Matt & Chrome Plated



DFSH-222
Glass to Glass 180° Hinge

Material : Forged Brass
Door Thickness : 8mm-12mm
Weight Cap. : 45kg
Finish : Matt & Chrome Plated

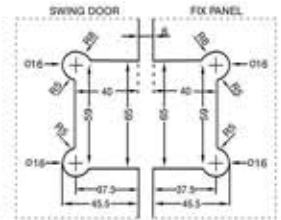

DFSH-3
Glass to Glass 135° Hinge

Material : SS 304
Door Thickness : 8mm-12mm
Weight Cap. : 45kg
Finish : Matt & Chrome Plated



DFSH-333
Glass to Glass 135° Hinge

Material : Forged Brass
Door Thickness : 8mm-12mm
Weight Cap. : 45kg
Finish : Matt & Chrome Plated

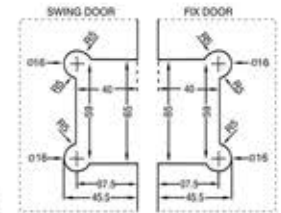

DFSH-4
Glass to Glass 90° Hinge

Material : SS 304
Door Thickness : 8mm-12mm
Weight Cap. : 45kg
Finish : Matt & Chrome Plated



DFSH-444
Glass to Glass 90° Hinge

Material : Forged Brass
Door Thickness : 8mm-12mm
Weight Cap. : 45kg
Finish : Matt & Chrome Plated

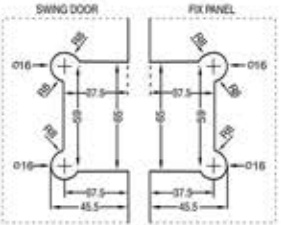

DFSH-5
Wall to Glass 90° Fix Bracket

Material : SS 304
Door Thickness : 8mm-12mm
Weight Cap. : 45kg
Finish : Matt & Chrome Plated



DFSH-555
Wall to Glass 90° Fix Bracket

Material : Forged Brass
Door Thickness : 8mm-12mm
Weight Cap. : 45kg
Finish : Matt & Chrome Plated

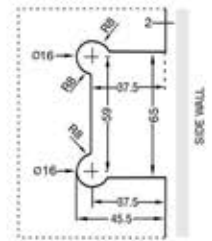

Hydraulic Shower Hinges



DFSH-01 H
Wall to Glass Hinge

Specification
Material : SS 304
Glass Thickness : 8mm-12mm
Weight Cap. : 45kg
Finish : Matt & Chrome Plated
With Gasket to Prevent Glass From Damage Secure Holding with Glass

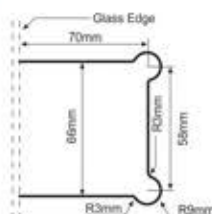

DFSH-02 H
Glass to Glass Hinge

Specification
Material : SS 304
Glass Thickness : 8mm-12mm
Weight Cap. : 45kg
Finish : Matt & Chrome Plated
With Gasket to Prevent Glass From Damage Secure Holding with Glass

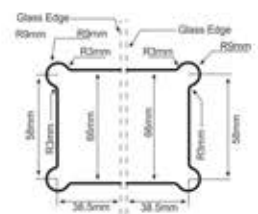



DFGC-1
U Connector

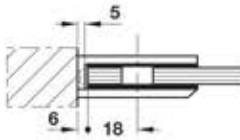

Material : WM / Brass
Door Thickness : 8mm-12mm
Finish : Matt & Chrome Plated



DFGC-111
U Connector

Material : SS 304
Door Thickness : 8mm-12mm
Finish : Matt & Chrome Plated

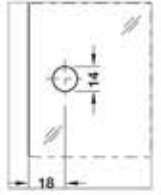

DFGC-2
Glass to Glass 135°

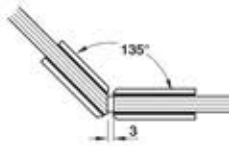

Material : WM / Brass
Door Thickness : 8mm-12mm
Finish : Matt & Chrome Plated



DFGC-222
Glass to Glass 135°

Material : SS 304
Door Thickness : 8mm-12mm
Finish : Matt & Chrome Plated

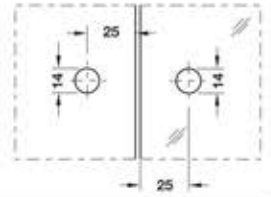

DFGC-3
Glass to Glass 90°

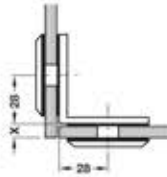

Material : WM / Brass
Door Thickness : 8mm-12mm
Finish : Matt & Chrome Plated



DFGC-333
Glass to Glass 90°

Material : SS 304
Door Thickness : 8mm-12mm
Finish : Matt & Chrome Plated

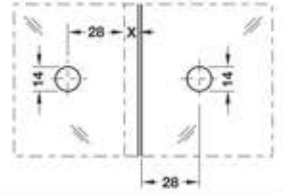

DFGC-4
L Connector

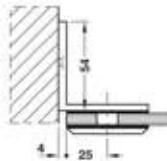

Material : WM / Brass
Door Thickness : 8mm-12mm
Finish : Matt & Chrome Plated



DFGC-444
L Connector

Material : SS 304
Door Thickness : 8mm-12mm
Finish : Matt & Chrome Plated

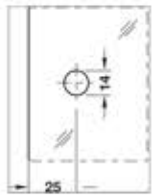

DFGC-5
Glass to Glass 180°

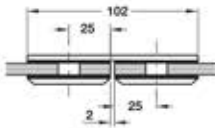

Material : WM / Brass
Door Thickness : 8mm-12mm
Finish : Matt & Chrome Plated



DFGC-555
Glass to Glass 180°

Material : SS 304
Door Thickness : 8mm-12mm
Finish : Matt & Chrome Plated

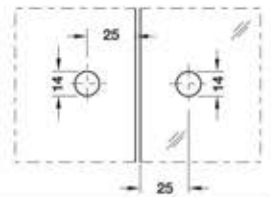



DFGC-11
U Connector

Material : SS 304
Door Thickness : 8mm-12mm
Finish : Matt & Chrome Plated



DFGC-11 BM
U Connector



DFGC-11 G
U Connector



DFGC-11 RG
U Connector

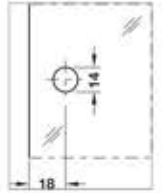

DFGC-22
Glass to Glass 135°

Material : SS 304
Door Thickness : 8mm-12mm
Finish : Matt & Chrome Plated



DFGC-22 BM
Glass to Glass 135°



DFGC-22 G
Glass to Glass 135°



DFGC-22 RG
Glass to Glass 135°

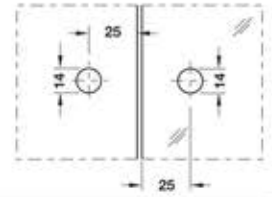

DFGC-33
Glass to Glass 90°

Material : SS 304
Door Thickness : 8mm-12mm
Finish : Matt & Chrome Plated



DFGC-33 BM
Glass to Glass 90°



DFGC-33 G
Glass to Glass 90°



DFGC-33 RG
Glass to Glass 90°

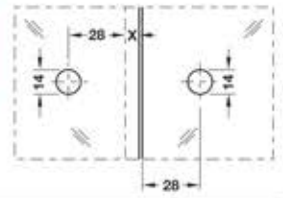

DFGC-44
L Connector

Material : SS 304
Door Thickness : 8mm-12mm
Finish : Matt & Chrome Plated



DFGC-44 BM
L Connector



DFGC-44 G
L Connector



DFGC-44 RG
L Connector

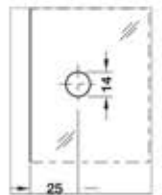

DFGC-55
Glass to Glass 180°

Material : SS 304
Door Thickness : 8mm-12mm
Finish : Matt & Chrome Plated



DFGC-55 BM
Glass to Glass 180°



DFGC-55 G
Glass to Glass 180°



DFGC-55 RG
Glass to Glass 180°

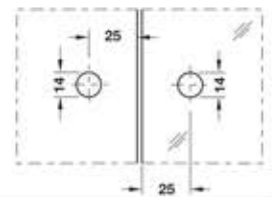

DFGC-66
T-Connector Glass to Glass 90°

Material : SS 304
Door Thickness : 8mm-12mm
Finish : Matt & Chrome Plated
Suitable for holding 3 glasses together



DFGC-66 BM
T-Connector
Glass to Glass 90°



DFGC-66 G
T-Connector
Glass to Glass 90°



DFGC-66 RG
T-Connector
Glass to Glass 90°

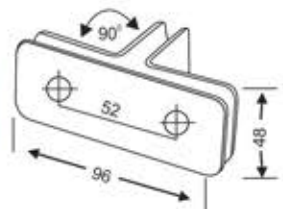

For : 8, 10, 12mm Glass
 Sizes :2.2mtr., 2.5mtr.

Transparent



DFGP-1 (Wall Seal)



DFGP-2 (Center Seal)

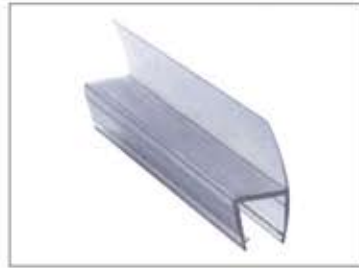

DFGP-3 (Side Seal)



DFGP-4 (D Seal)



DFGP-5 (Soft Nose Seal)



DFGP-6 (Sliding Door Seal)



DFGP-7 (Water Dispersal Seal)



DFGP-M1 180° (Magnetic Seal)



DFGP-M2 135° (Magnetic Seal)



DFGP-M3 90° / 180° (Magnetic Seal)

Black



DFGP-1 BM (Wall Seal)



DFGP-2 BM (Center Seal)



DFGP-3 BM (Side Seal)



DFGP-4 BM (D Seal)



DFGP-5 BM (Soft Nose Seal)



DFGP-6 BM (Sliding Door Seal)



DFGP-7 BM (Water Dispersal Seal)



DFGP-M1 BM 180° (Magnetic Seal)



DFGP-M2 BM 135° (Magnetic Seal)



DFGP-M3 BM 90° / 180° (Magnetic Seal)



PVC PROFILES

For : 8, 10, 12mm Glass
Sizes :2.2mtr., 2.5mtr.

Gold



DFGP-1G (Wall Seal)



DFGP-2 G (Center Seal)



DFGP-3 G (Side Seal)



DFGP-4 G (D Seal)



DFGP-5 G (Soft Nose Seal)



DFGP-6 G (Sliding Door Seal)



DFGP-7 G (Water Dispersal Seal)



DFGP-M1 G 180° (Magnetic Seal)



DFGP-M2 G 135° (Magnetic Seal)



DFGP-M3 G 90° / 180° (Magnetic Seal)

Rose Gold



DFGP-1 RG (Wall Seal)



DFGP-2 RG (Center Seal)



DFGP-3 RG (Side Seal)



DFGP-4 RG (D Seal)



DFGP-5 RG (Soft Nose Seal)



DFGP-6 RG (Sliding Door Seal)

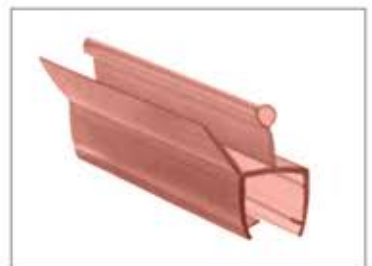

DFGP-7 RG (Water Dispersal Seal)



DFGP-M1 RG 180° (Magnetic Seal)



DFGP-M2 RG 135° (Magnetic Seal)



DFGP-M3 RG 90° / 180° (Magnetic Seal)

Round Series Dia 19mm



DFKH-1
Wall to Rod

Specification
Finish : Satin Nikle/Chrome Plated
Material : Stainless Steel 304 Grade/ Brass
Reinforcing connector wall to rod



DFKH-1 BM
Wall to Rod



DFKH-1 G
Wall to Rod



DFKH-1 RG
Wall to Rod

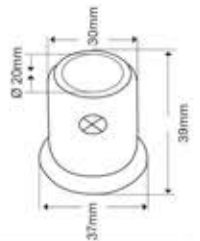

DFKH-2
Rod to Glass

Specification
Finish : Satin Nikle/Chrome Plated
Material : Stainless Steel 304 Grade/ Brass
Reinforcing connector rod to glass



DFKH-2 BM
Rod to Glass



DFKH-2 G
Rod to Glass



DFKH-2 RG
Rod to Glass

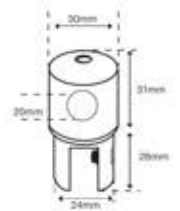

DFKH-3
Rod to Rod

Specification
Finish : Satin Nikle/Chrome Plated
Material : Stainless Steel 304 Grade/ Brass
Reinforcing connector rod to rod (Adjustable Angle)



DFKH-3 BM
Rod to Rod



DFKH-3 G
Rod to Rod



DFKH-3 RG
Rod to Rod

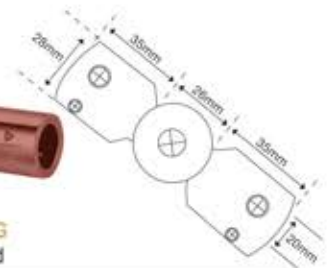

DFKH-4
Rod to Glass
(One Side Blind)

Specification
Finish : Satin Nikle/Chrome Plated
Material : Stainless Steel 304 Grade/ Brass
Reinforcing connector rod to glass (One side blind)



DFKH-4 BM
Rod to Glass
(One Side Blind)



DFKH-4 G
Rod to Glass
(One Side Blind)



DFKH-4 RG
Rod to Glass
(One Side Blind)

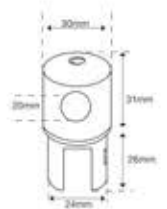

DFKH-5
Rod to Rod T Connector

Specification
Finish : Satin Nikle/Chrome Plated
Material : Stainless Steel 304 Grade/ Brass
Reinforcing connector rod to rod (T-Type)



DFKH-5 BM
Rod to Rod
T Connector



DFKH-5 G
Rod to Rod
T Connector



DFKH-5 RG
Rod to Rod
T Connector

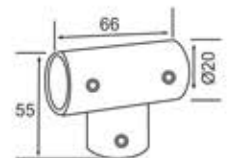

DFKH-ACC-19
Reinforcing Rod

Specification
19mm outer diameter pipe
Available in 2 & 3 mtr. length
Material : Stainless Steel 304 Grade



DFKH-ACC-19 BM
Reinforcing Rod



DFKH-ACC-19 G
Reinforcing Rod



DFKH-ACC-19 RG
Reinforcing Rod

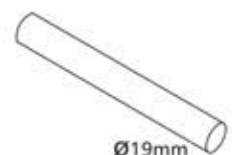

SHOWER KNIGHT HEAD ACCESSORIES

Square Series Dia 25mm



DFKH-11
Wall to Rod

Specification
Finish : Satin Nikle/Chrome Plated
Material : Stainless Steel 304 Grade
Reinforcing connector wall to rod



DFKH-11 BM
Wall to Rod



DFKH-11 G
Wall to Rod



DFKH-11 RG
Wall to Rod

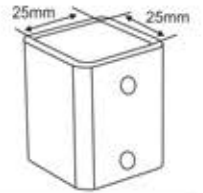

DFKH-22
Rod to Glass

Specification
Finish : Satin Nikle/Chrome Plated
Material : SS 304 Grade
Reinforcing connector rod to glass



DFKH-22 BM
Rod to Glass



DFKH-22 G
Rod to Glass



DFKH-22 RG
Rod to Glass

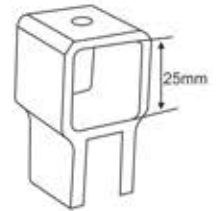

DFKH-33
Rod to Rod

Specification
Finish : Satin Nikle/Chrome Plated
Material : SS 304 Grade
Reinforcing connector rod to rod
(Adjustable Angle)



DFKH-33 BM
Rod to Rod



DFKH-33 G
Rod to Rod



DFKH-33 RG
Rod to Rod

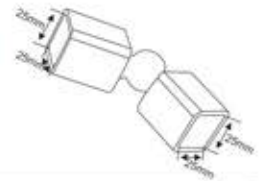

DFKH-44
Rod to Glass
(One Side Blind)

Specification
Finish : Satin Nikle/Chrome Plated
Material : SS 304 Grade
Reinforcing connector rod to glass
(One side blind)



DFKH-44 BM
Rod to Glass
(One Side Blind)



DFKH-44 G
Rod to Glass
(One Side Blind)



DFKH-44 RG
Rod to Glass
(One Side Blind)

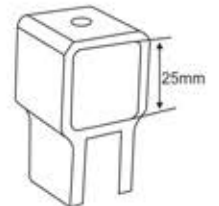

DFKH-55
Rod to Rod T Connector

Specification
Finish : Satin Nikle/Chrome Plated
Material : SS 304 Grade
Reinforcing connector rod to rod (T-Type)



DFKH-55 BM
Rod to Rod
T Connector



DFKH-55 G
Rod to Rod
T Connector



DFKH-55 RG
Rod to Rod
T Connector

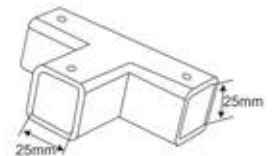

DFKH-ACC-25x25
Connecting Track

Specification
25mm outer diameter pipe
Available in 2 & 3 mtr. length
Material : Stainless Steel 304 Grade



DFKH-ACC-25x25 BM
Connecting Track



DFKH-ACC-25x25 G
Connecting Track



DFKH-ACC-25x25 RG
Connecting Track

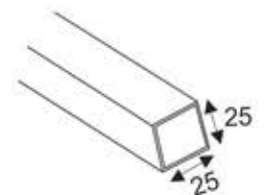

Rectangle Series 10X30mm



DFKH-111
Wall to Track Connector

Specification
For mounting with wall
Rectangular design
With two grub screws to prevent
relative movement
Material : SS 304 Grade



DFKH-111 BM
Wall to Rod



DFKH-111 G
Wall to Rod



DFKH-111 RG
Wall to Rod

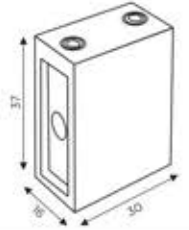

DFKH-222
Track to Glass Connector

Specification
For mounting with wall
Rectangular design
With two grub screws to prevent
relative movement
Material : SS 304 Grade



DFKH-222 BM
Rod to Glass



DFKH-222 G
Rod to Glass



DFKH-222 RG
Rod to Glass

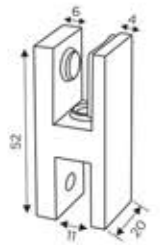

DFKH-333
Track to Track Connector

Specification
Glass to track end connector
With two grub screws to prevent
relative movement
Material : SS 304 Grade



DFKH-333 BM
Rod to Rod



DFKH-333 G
Rod to Rod



DFKH-333 RG
Rod to Rod

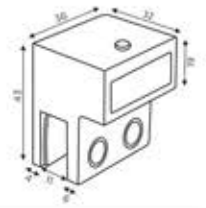

DFKH-ACC-10/30
Connecting Track
(Available in 1.5 Mt, 1.8 Mt & 2.1 Mt)

Specification
Rectangular design
Available in 1.5, 1.8, 2.1 mtr. length
Material : SS 304 Grade



DFKH-ACC-10/30
Connecting Track
(Available in 1.5 Mt, 1.8 Mt & 2.1 Mt)



DFKH-ACC-10/30
Connecting Track
(Available in 1.5 Mt, 1.8 Mt & 2.1 Mt)



DFKH-ACC-10/30
Connecting Track
(Available in 1.5 Mt, 1.8 Mt & 2.1 Mt)

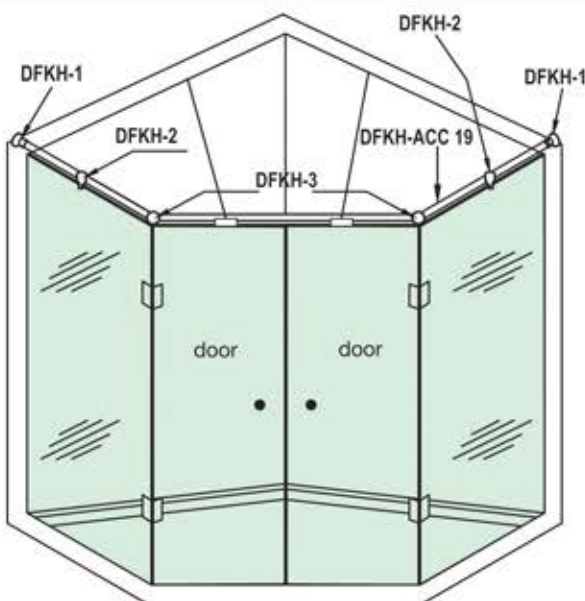



DOOR KNOBS



DFDK-1 Door Knob

Specification
Material : Stainless Steel 304
Applicable for 8mm to 12mm glass
Suitable for Glass Door



DFDK-1 BM Door Knob



DFDK-1 G Door Knob



DFDK-1 RG Door Knob

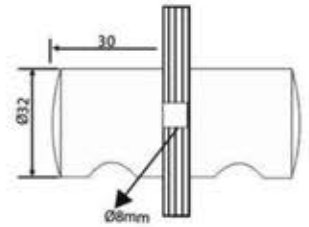

DFDK-2 Door Knob

Specification
Material : Stainless Steel 304
Applicable for 8mm to 12mm glass
Suitable for Glass Door



DFDK-2 BM Door Knob



DFDK-2 G Door Knob



DFDK-2 RG Door Knob

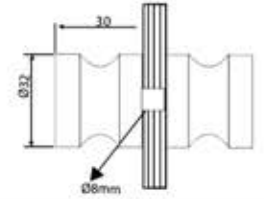

DFDK-22 Door Knob

Specification
Material : Stainless Steel 304
Applicable for 8mm to 12mm glass
Suitable for Glass Door



DFDK-22 BM Door Knob



DFDK-22 G Door Knob



DFDK-22 RG Door Knob

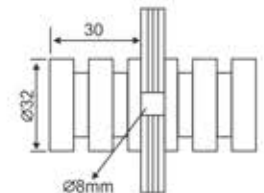

DFDK-44 Door Knob

Specification
Material : Stainless Steel 304
Applicable for 8mm to 12mm glass
Suitable for Glass Door



DFDK-44 BM Door Knob



DFDK-44 G Door Knob



DFDK-44 RG Door Knob

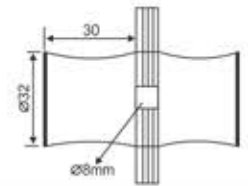

SHOWER HANDLES



DFDH-TB-01 Shower Handles
Sizes :
19x152x457CC
25x152x457CC

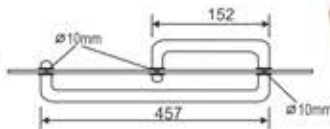

DFDH-TB-01 BM Shower Handles



DFDH-TB-01G Shower Handles



DFDH-TB-01 RG Shower Handles



DFDH-TB-02 Shower Handle
Sizes :
15/30x152x457CC

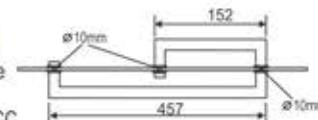

DFDH-TB-02 BM Shower Handle



DFDH-TB-02 G Shower Handle



DFDH-TB-02 RG Shower Handle



SHOWER SLIDING SET (DFSL-11ED)

DFSL-11-ED Set



- DFSL-11ED - 2 Big Roller, 2 Small Roller
- DFSL-11ED-A2 - 2 Track to Glass Holder
- DFSL-11ED-A3 - 2 Stopper
- DFSL-11ED-A4 - 1 Floor Guide
- DFSL-1ED - 2 Wall to Track Connector
- DFSL-HN-50 - 1 Sliding Handle

DFKH-ACC-10/30
Connecting Track

DFSL-11-ED Set (Black Matt)



- DFSL-11ED BM - 2 Big Roller, 2 Small Roller
- DFSL-11ED-A2 BM - 2 Track to Glass Holder
- DFSL-11ED-A3 BM - 2 Stopper
- DFSL-11ED-A4 BM - 1 Floor Guide
- DFSL-1ED BM - 2 Wall to Track Connector
- DFSL-HN-50 BM - 1 Sliding Handle

DFKH-ACC-10/30 BM
Connecting Track

DFSL-11-ED1 Set (Gold)



- DFSL-11ED G - 2 Big Roller, 2 Small Roller
- DFSL-11ED-A2 G - 2 Track to Glass Holder
- DFSL-11ED-A3 G - 2 Stopper
- DFSL-11ED-A4 G - 1 Floor Guide
- DFSL-1ED G - 2 Wall to Track Connector
- DFSL-HN-50 G - 1 Sliding Handle

DFKH-ACC-10/30 BM
Connecting Track

DFSL-11-ED Set (Rose Gold)



- DFSL-11ED RG - 2 Big Roller, 2 Small Roller
- DFSL-11ED-A2 RG - 2 Track to Glass Holder
- DFSL-11ED-A3 RG - 2 Stopper
- DFSL-11ED-A4 RG - 1 Floor Guide
- DFSL-1ED RG - 2 Wall to Track Connector
- DFSL-HN-50 RG - 1 Sliding Handle

DFKH-ACC-10/30 BM
Connecting Track

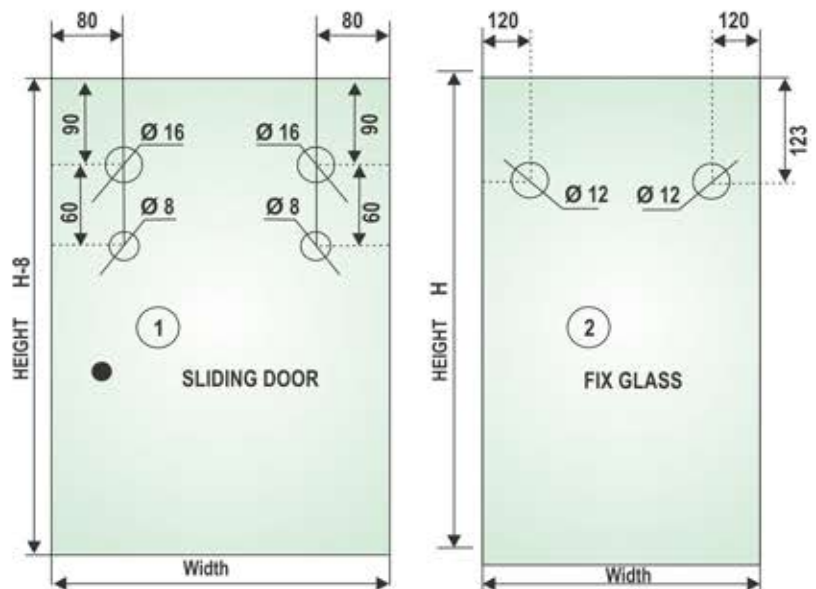



SOFT CLOSE SLIDING SYSTEM

DORFIX

DFSS-1001 (Set)

Soft Close Sliding System Door Weight upto 110 KG.



PSC-1
Roller



PSC-2
Hydraulic Damper



PSC-3
Stopper



PSC-4
Floor Guide

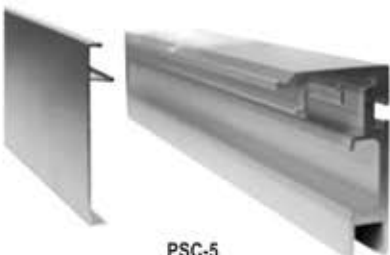

PSC-5
Aluminium Sliding Track
Available in : 2.2, 2.5, 3, 4.4 and 5.5 Mtr

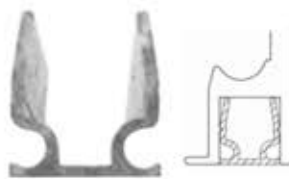

PSC-6
Groove Cover



PSC-7
Sealing Cap



PSL-HN-50
Sliding Door Handle

SLIDING SET

DFSL-44-A1 Set



DFSL-44-A1 (Metal Body)
(One Box Contains)
2 set Rollers (S.S.)
2 set Stoppers
1 Floor Guides



DFSL-44-A1 (Plastic Body)
(One Box Contains)
2 set Rollers (S.S.)
2 set Stoppers
1 Floor Guides

Specification

Four fiber reinforced plastic rollers of 30 mm diameter
Stainless Steel Grade 304 / Plastic glass holding point
Height adjustable glass holding points (10 mm)
Secure grip for the door
Self aligning suspension of door
Roller configuration for even distribution of load
Independently connected rollers to prevent damage to track and rollers
Suitable for 10 mm or 12 mm glass
Suitable for door weight 40 kg.

CUTOUT DETAILS OF SSL-44-A1 and SSL-44-A2

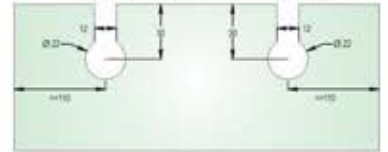

DFSL-44-A1 BM (Metal Body)
(One Box Contains)
2 set Rollers (S.S.)
2 set Stoppers
1 Floor Guides



DFSL-44-A1 G (Metal Body)
(One Box Contains)
2 set Rollers (S.S.)
2 set Stoppers
1 Floor Guides



DFSL-44-A1 RG (Metal Body)
(One Box Contains)
2 set Rollers (S.S.)
2 set Stoppers
1 Floor Guides

DFSL-44-A2 Set



DFSL-44-A2 (Metal Body)
(One Box Contains)
2 set Rollers (S.S.)
2 set Stoppers
1 Floor Guides



DFSL-44-A2 (Plastic Body)
(One Box Contains)
2 set Rollers (S.S.)
2 set Stoppers
1 Floor Guides

Specification

Heavy duty sliding door roller
Suitable for up to a door weight of 80 Kg
Larger surface area for secure grip of the door
Adjustable threaded rod for installation perfection
Solid brass for glass holding

CUTOUT DETAILS OF SSL-44-A1 and SSL-44-A2



DFSL-44-A2 BM (Metal Body)
(One Box Contains)
2 set Rollers (S.S.)
2 set Stoppers
1 Floor Guides



DFSL-44-A2 G (Metal Body)
(One Box Contains)
2 set Rollers (S.S.)
2 set Stoppers
1 Floor Guides



DFSL-44-A2 RG (Metal Body)
(One Box Contains)
2 set Rollers (S.S.)
2 set Stoppers
1 Floor Guides

SLIDING SET

DFSL-44-R8 Set



DFSL-44-R8 (Metal Body)
 (One Box Contains)
 2 set Rollers (S.S.)
 2 set Stoppers
 1 Floor Guides

Specification
 • Material : Stainless steel 304 grade
 • Finish : Satin stainless steel (SSS)

CUTOUT DETAILS OF SSL-44-R8

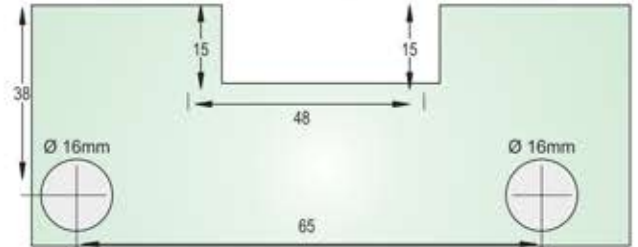

DFSL-A11
 8 Wheel Both Side Soft Close Sliding Fitting (Round)



DFSL-A22
 8 Wheel Both Side Soft Close Sliding Fitting (Big Round)

OFFICE AND RESIDENTIAL SLIDING ROLLER FOR WOODEN



DFSL-WD-80 | Sliding System Set
 W/O Track for Single Frame less Door of 80 kg



DFSL-WD-100 | Sliding System Set
 W/O Track for Single Frame less/ Wooden Door of 100 kg



DFSL-44-A5
 Wall to Track Clamp



DFSL-44-A6
 Glass to Track Clamp



DFSL-44-A8
 90° Track Connector



DFSL-44-A9
 Wall to Track Connector



DFSL-33G
 Floor Guide



DFSL-33G BM
 Floor Guide



DFSL-33G G
 Floor Guide



DFSL-33G RG
 Floor Guide



DFSL-HN-50
 Sliding Handle
 (Dia 50mm)

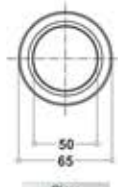

DFSL-HN-50 BM
 Sliding Handle
 (Dia 50mm)



DFSL-HN-50 G
 Sliding Handle
 (Dia 50mm)



DFSL-HN-50 RG
 Sliding Handle
 (Dia 50mm)



DFSL-HN-60
 Sliding Handle
 (Dia 60mm)



DFSL-HN-60
 Sliding Handle
 (Dia 60mm)



SLIDING TRACK SPARKLE FINISH

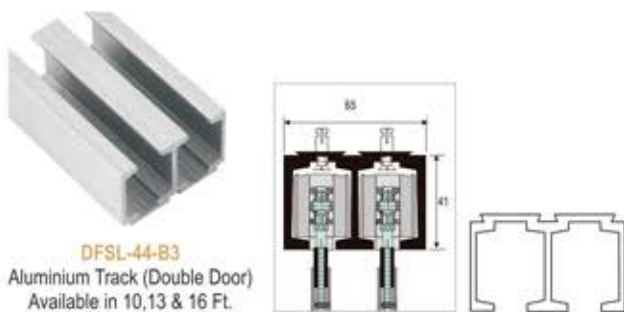
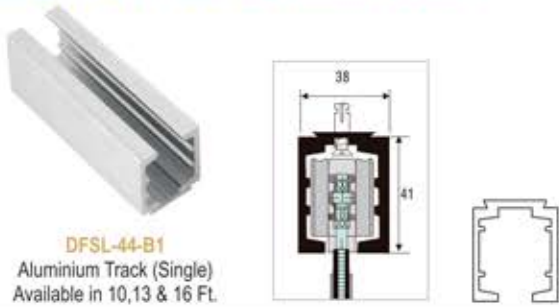



DFCFS-1
Folding Door Roller

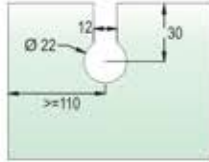

DFCFS-1 BM
Folding Door Roller



DFCFS-1 G
Folding Door Roller



DFCFS-1 RG
Folding Door Roller



DFCFS-2
Glass to Wall Hinge

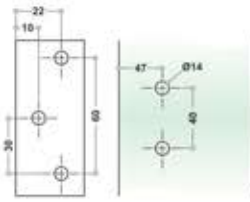

DFCFS-2 BM
Glass to Wall Hinge



DFCFS-2 G
Glass to Wall Hinge



DFCFS-2 RG
Glass to Wall Hinge



DFCFS-3
Glass to Glass Hinge

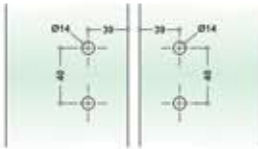

DFCFS-3 BM
Glass to Glass Hinge



DFCFS-3 G
Glass to Glass Hinge



DFCFS-3 RG
Glass to Glass Hinge



DFCFS-LK
Sliding Glass Door Lock



DFCFS-LK BM
Sliding Glass Door Lock



DFCFS-LK G
Sliding Glass Door Lock



DFCFS-LK RG
Sliding Glass Door Lock



DFCFS-5
Knob Sleeve



DFCFS-5 BM
Knob Sleeve



DFCFS-5 G
Knob Sleeve



DFCFS-5 RG
Knob Sleeve



DFCFS-4
Glass Door Knob



DFCFS-4 BM
Glass Door Knob



DFCFS-4 G
Glass Door Knob



DFCFS-4 RG
Glass Door Knob

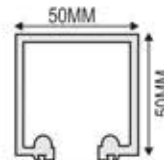

DFCFS-6
Aluminium Track
Available in 4 Mt.



DFCFS-6 BM
Aluminium Track
Available in 4 Mt.

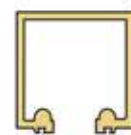

DFCFS-6 G
Aluminium Track
Available in 4 Mt.



DFCFS-6 RG
Aluminium Track
Available in 4 Mt.

ORDERING INFORMATION FOR FRAMELESS CENTER FOLDING SYSTEM (DFCFS)

CODE	DFCFS-1	DFCFS-12	DFCFS-3
AGSF-201-For 2 Door	1	2	2
AGSF-201-For 3 Door	2	2	4
AGSF-201-For 4 Door	3	2	6
AGSF-201-For 5 Door	4	2	8

Note : -
 Maximum weight per door : 70kg
 Maximum width per door : 900mm
 Maximum height per door : 2500mm
 Suitable for 8 to 10mm glass thickness



No need to grout in the floor with frameless center folding systems
 Suitable for mall, showrooms, hotels and airport, etc.

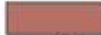

DFSFS-201 B

Also Available in :  
Gold Rose Gold



DFSFS-A6
Glass to Glass Center Hinge



DFSFS-A6 BM
Glass to Glass Center Hinge

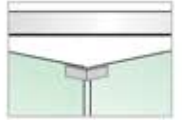
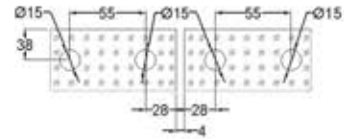
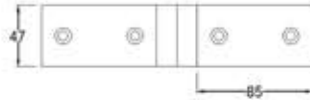

DFSFS-A13 L/R
Glass to Glass Center Hinge with Lock



DFSFS-A13 L/R BM
Glass to Glass Center Hinge with Lock

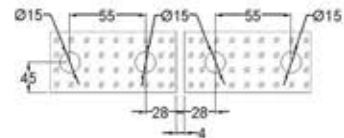
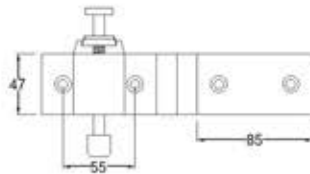

DFSFS-201 C



DFSFS-A10
Center Hinge with Roller



DFSFS-A10 BM
Center Hinge with Roller

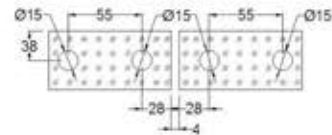
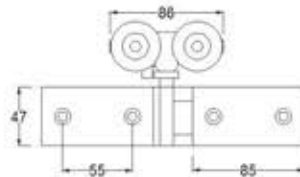

DFSFS-A12
Glass to Glass Center Hinge with Guide



DFSFS-A12 BM
Glass to Glass Center Hinge with Guide

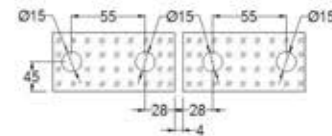
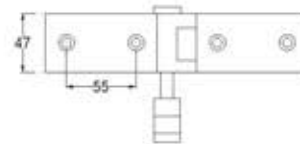

DFSFS-201 D



DFSFS-A11
End Hinge with Roller



DFSFS-A11 BM
End Hinge with Roller

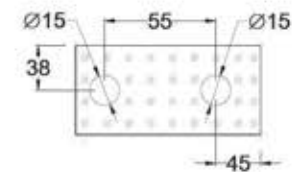
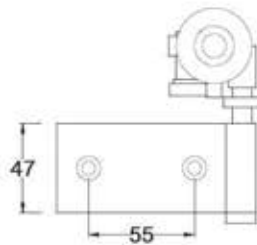

DFSFS-A14
End Hinge with Guide



DFSFS-A14 BM
End Hinge with Guide

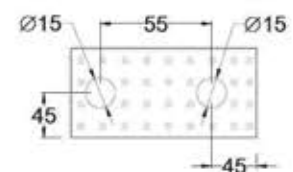
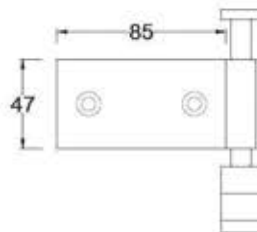



GLASS SLIDING FOLDING SYSTEM

DORFIX

DFSFS-201 P

Also Available in :
Gold Rose Gold



DFSFS-A16
Fixed Hinge



DFSFS-A16 BM
Fixed Hinge

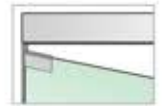
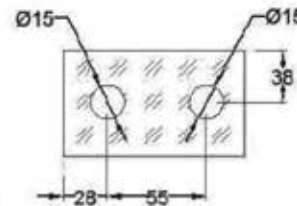
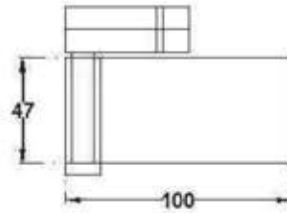

DFSFS-A17
Floor Fixed Hinge



DFSFS-A17 BM
Floor Fixed Hinge

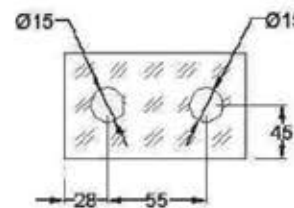
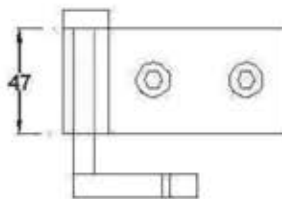

DFSFS-1
Aluminium Track (Top)
Available in 12 Ft.



DFSFS-1 BM
Aluminium Track (Top)
Available in 12 Ft.



DFSFS-2
Floor Track Bottom (S.S.)



DFSFS-2 BM
Floor Track Bottom (Alu.)

ORDERING INFORMATION FOR GLASS SLIDING FOLDING SYSTEM (DFSFS)

CODE	DFSFS-201 P	DFSFS-201 B	DFSFS-201 C	DFSFS-201 D
For 2 Glass Panel	01 Set	01 Set	--	01 Set
For 3 Glass Panel	01 Set	01 Set	01 Set	--
For 4 Glass Panel	01 Set	02 Set	01 Set	01 Set
For 5 Glass Panel	01 Set	02 Set	02 Set	--
For 6 Glass Panel	01 Set	03 Set	02 Set	01 Set

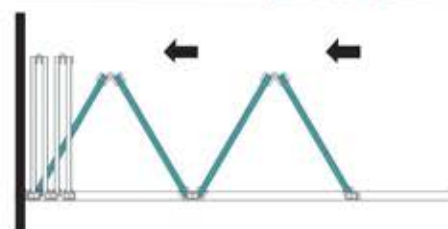

SLIDING SET (DFSL-33A)

DFSL-33A Set



DFSL-33-TH-WL
Wall to Rod Holder



DFSL-33-TH
Wall to Rod Clamp



DFSL-33G
Floor Guide



DFSL-33-TH-G2
Glass to Rod Clamp



DFSL-33B
Door Stopper



DFSL-33H
Glass to Glass
Connector 180°

DFSL-33A - 2 Sliding Roller, DFSL-33-TH-G2 - 4 Glass to Rod Clamp
DFSL-33G - 1 Floor Guide, DFSL-33B - 2 (L R) Door Stopper
2 Cap + 1 Fastner

DFSL-33A Set (Black Matt)



DFSL-33-TH-WL BM
Wall to Rod Holder



DFSL-33-TH BM
Wall to Rod Clamp



DFSL-33G BM
Floor Guide



DFSL-33-TH-G2 BM
Glass to Rod Clamp



DFSL-33B BM
Door Stopper



DFSL-33H BM
Glass to Glass
Connector 180°

DFSL-33A BM - 2 Sliding Roller, DFSL-33-TH-G2 BM - 4 Glass to Rod Clamp
DFSL-33G BM - 1 Floor Guide, DFSL-33B BM - 2 (L R) Door Stopper
2 Cap + 1 Fastner

DFSL-33A Set (Gold)



DFSL-33-TH-WL G
Wall to Rod Holder



DFSL-33-THG
Wall to Rod Clamp



DFSL-33G G
Floor Guide



DFSL-33-TH-G2 G
Glass to Rod Clamp



DFSL-33B G
Door Stopper



DFSL-33H G
Glass to Glass
Connector 180°

DFSL-33A G - 2 Sliding Roller, DFSL-33-TH-G2 G - 4 Glass to Rod Clamp
DFSL-33G G - 1 Floor Guide, DFSL-33B G - 2 (L R) Door Stopper
2 Cap + 1 Fastner

DFSL-33A Set (Rose Gold)



DFSL-33-TH-WL RG
Wall to Rod Holder



DFSL-33-TH
Wall to Rod Clamp



DFSL-33G RG
Floor Guide



DFSL-33-TH-G2 RG
Glass to Rod Clamp



DFSL-33B RG
Door Stopper



DFSL-33H RG
Glass to Glass
Connector 180°

DFSL-33A RG - 2 Sliding Roller, DFSL-33-TH-G2 RG - 4 Glass to Rod Clamp
DFSL-33G RG - 1 Floor Guide, DFSL-33B RG - 2 (L R) Door Stopper
2 Cap + 1 Fastner



DFSL-33-TH-G2
Glass to Rod Clamp



DFSL-33-TH-G2 BM
Glass to Rod Clamp



DFSL-33-TH-G2 G
Glass to Rod Clamp



DFSL-33-TH-G2 RG
Glass to Rod Clamp



DFSL-33-TH
Wall to Rod Clamp



DFSL-33-THBM
Wall to Rod Clamp



DFSL-33-THG
Wall to Rod Clamp



DFSL-33-TH RG
Wall to Rod Clamp



DFSL-ACC-25
Shower Sliding Pipe



DFSL-ACC-25 BM
Shower Sliding Pipe



DFSL-ACC-25 G
Shower Sliding Pipe



DFSL-ACC-25 RG
Shower Sliding Pipe



DFSL-33-TH-WL



DFSL-33-TH-G2



DFSL-33G



DFSL-33B



DFSL-33-TH



DFSL-33H

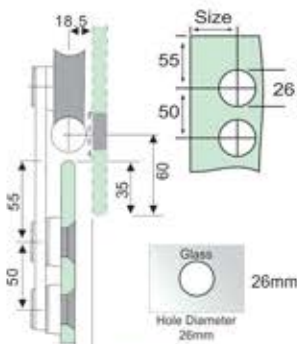

DFSL-33A



MANET SLIDING SYSTEM

DFSL-M-D22 Set



- DFSLM-D22 - 2 Roller
- DFSL-11-A3 - 2 Stopper
- DFSL-11-A4 - 1 Floor Guide
- DFSL-1 - 2 Wall to Track Connector
- DFSL-HN-50 - 1 Sliding Handle



FRAMELESS TELESCOPIC SYSTEM



Door Guide



Aluminium Hanger



Soft Closing



Door Roller



Aluminium Track



Door Belt

SYS SLIDING SYSTEM SET

SYS Sliding System Set (SS)



Knob Clamp Roller (SS)



Track Mounting Bracket



Door Stopper



Floor Guide

Top Track

SYS Sliding System Set (Black Matt)



Knob Clamp Roller (SS)



Track Mounting Bracket



Door Stopper



Floor Guide

Top Track

SYS Sliding System Set (Gold)



Knob Clamp Roller (SS)



Track Mounting Bracket



Door Stopper



Floor Guide

Top Track

SYS Sliding System Set (Rose Gold)



Knob Clamp Roller (SS)



Track Mounting Bracket



Door Stopper



Floor Guide

Top Track

Track to Track 90° Bracket



Track to Track 90° Bracket (Extra)



Track to Track 90° Bracket (Extra) BM



Track to Track 90° Bracket (Extra)G



Track to Track 90° Bracket (Extra) RG

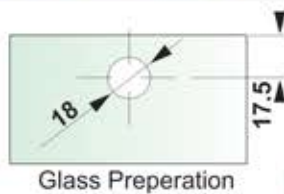

Features :

- Sliding Door Weight: 50kg Max.
- Sliding Door Size: 750x2000mm Max.
- Glass Thickness: 8 to 10mm





* Customized solutions can be provided according to the requirements of projects.

CANOPY FITTINGS



DFCF-1
Wall to Glass Connector

Specification
Finish : Satin stainless steel (SSS)
Suitable for canopies in interior & exterior
Stainless steel 304 grade
To fix glass with the wall
Adjustable angle
Washer to prevent glass from damage

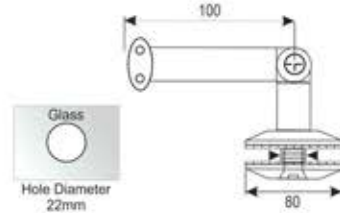

DFCF-2
Rod to Glass Connector

Specification
Finish : Satin stainless steel (SSS)
Suitable for holding canopy glass with rod along with wall to rod
Stainless steel 304 grade
To hold canopy glass with rod
Adjustable angle
Washer to prevent glass from damage

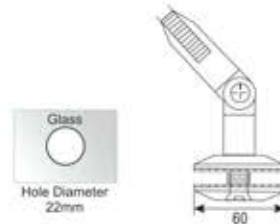

DFCF-3
Wall to Rod Connector

Specification
Finish : Satin stainless steel (SSS)
Suitable for holding wall to rod with wall
Stainless steel 304 grade
To hold rod with the wall
Adjustable angle
Washer to prevent glass from damage

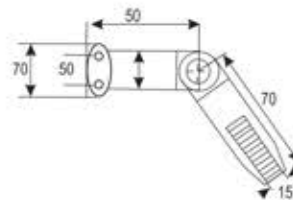

DFCF-ROD (16mm)
Canopy Rod with Thread

Specification
Finish : Satin stainless steel (SSS)
Suitable for fixing with pivot pole (top)
Stainless steel 304 grade
To be fix to a secured over panel
Available with countersunk/flat head



POINT FIXED GLASS CONNECTORS



DFPC-1
Wall to Glass (Adjustable)
(Available in 82mm & 103mm)



DFPC-1A
Wall to Glass (Fix)
(Available in 82mm & 103mm)



DFPC-2
Glass to Glass (Adjustable)
(Available in 82mm & 103mm)



DFPC-2A
Glass to Glass (Adjustable with Fin)
(Available in 82mm & 103mm)

TELESCOPIC SLIDING SYSTEM 1+1 DOOR

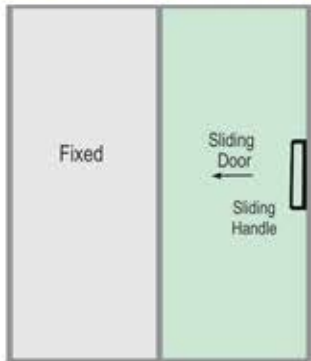

DTSS-1 (1+1)
Telescopic Sliding System

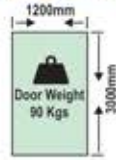

- Single Door Telescopic Accessories Set.**
 Sliding Top Track.
 Track Decorative Cover .
 Top & Bottom Profile.
 Side Profile.
 Handles.
 Divider Profile as Per Requirement.

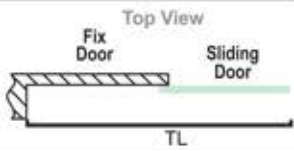

TELESCOPIC SLIDING SYSTEM 2+1 DOOR



DTSS-2 (2+1)
Telescopic Sliding System



- 2 Door Telescopic Accessories Set.**
 Sliding Top Track.
 Track Decorative Cover .
 Top & Bottom Profile.
 Side Profile.
 Handles.
 Divider Profile as Per Requirement.

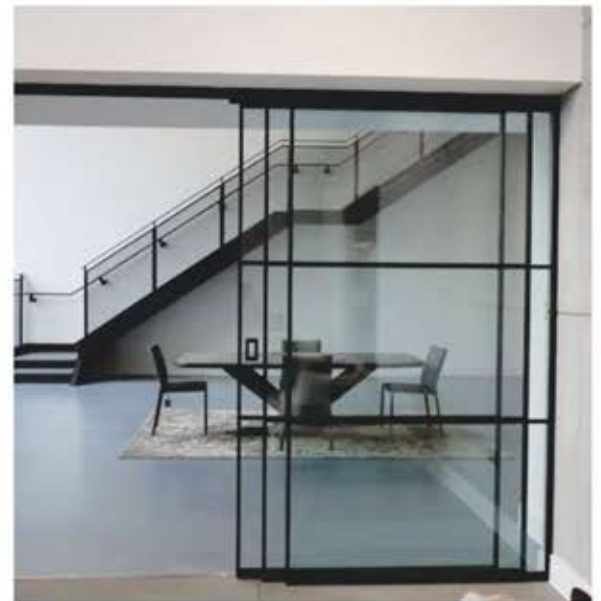
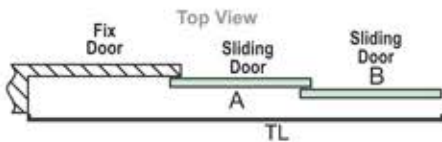

TELESCOPIC SLIDING SYSTEM 3+1 DOOR

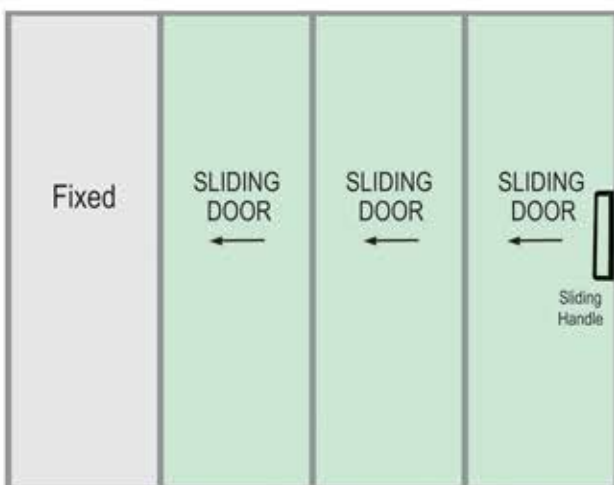

DTSS-3 (3+1)
Telescopic Sliding System



- 3 Door Telescopic Accessories Set.**
 Sliding Top Track.
 Track Decorative Cover .
 Top & Bottom Profile.
 Side Profile.
 Handles.
 Divider Profile as Per Requirement.

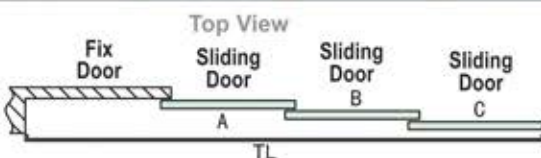



TELESCOPIC AND SYNCHRONIZED SLIDING SYSTEM

TELESCOPIC SLIDING SYSTEM 4+1 DOOR

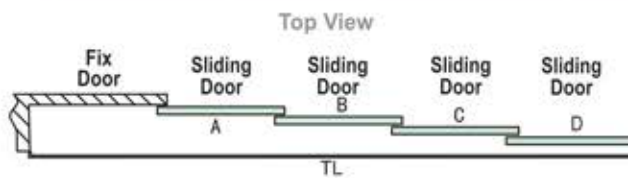
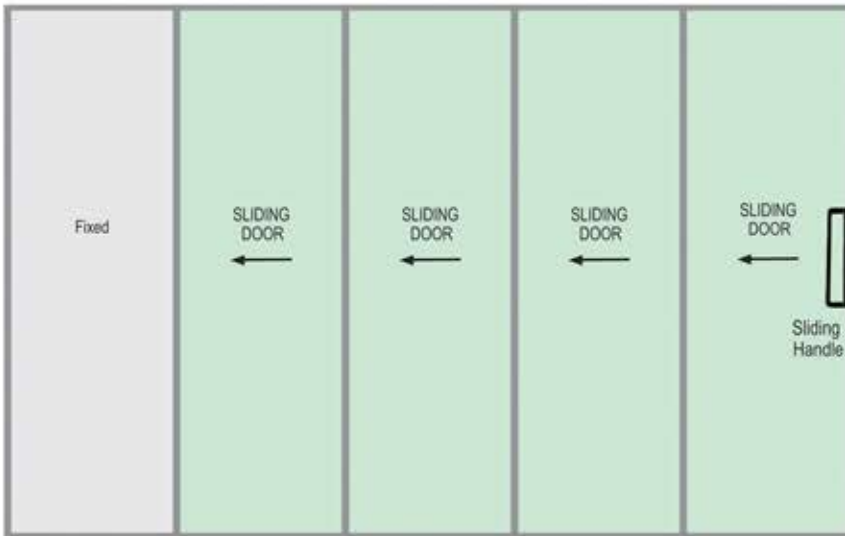

DTSS-4 (4+1)
Telescopic Sliding System



- 4 Door Telescopic Accessories Set.**
- Sliding Top Track.
 - Track Decorative Cover .
 - Top & Bottom Profile.
 - Side Profile.
 - Handles.
 - Divider Profile as Per Requirement.

SYNCHRONIZED SLIDING SYSTEM 2+2 DOOR

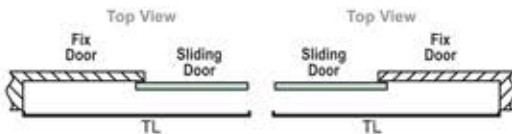
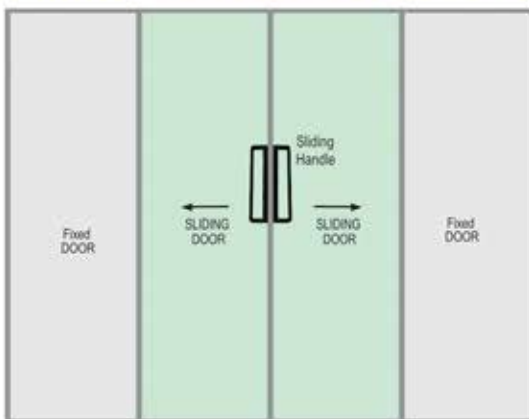

DTSS-22 (2+2)
Synchro Sliding System



- Synchronized Accessories Set.**
- Sliding Top Track.
 - Track Decorative Cover .
 - Top & Bottom Profile.
 - Side Profile.
 - Handles.
 - Divider Profile as Per Requirement.





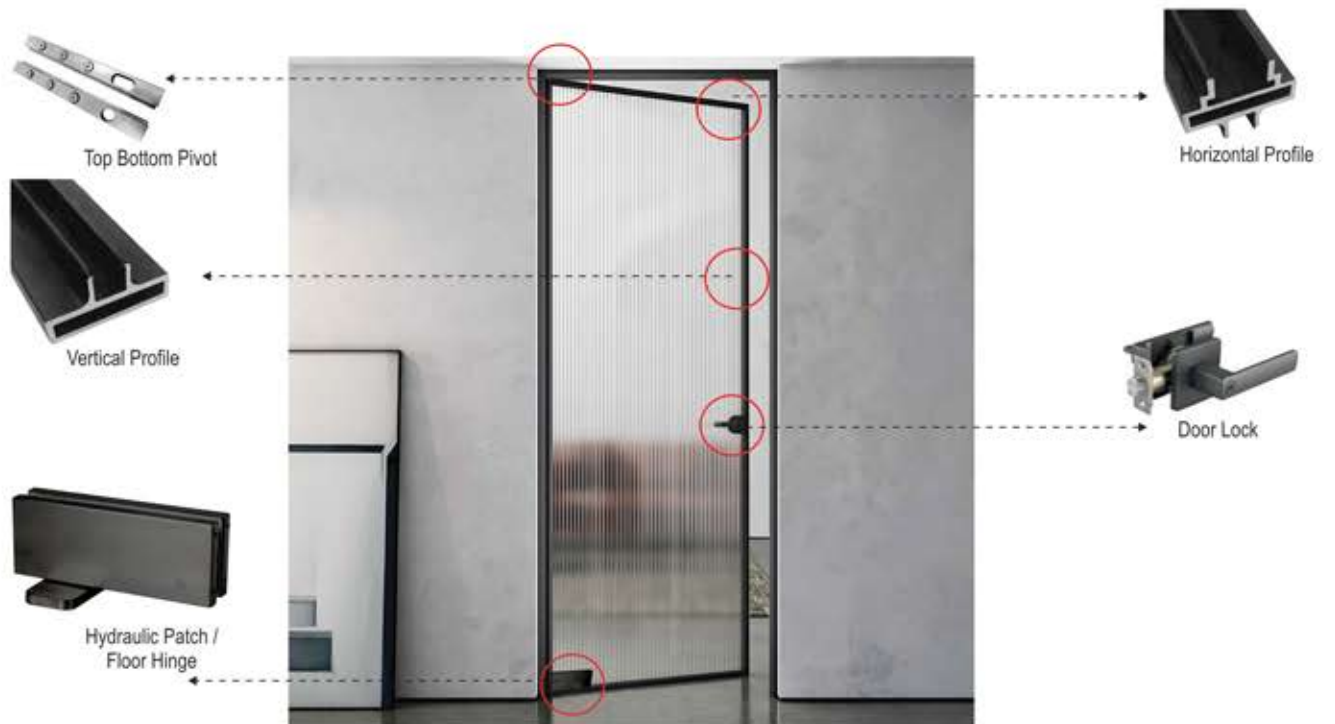

SYNCHRONIZED SLIDING SYSTEM 2+2 Door



TELESCOPIC SLIDING SYSTEM 3+1 Door



SLIM PROFILE ACCESSORIES



DSPA-13
Glass Lock



DSPA-14
Magnetic Glass Lock



DSPA-15
Bio Metric Door Lock



DSPA-16 (25x45)
Door Hinge (Oval)



DSPA-17
Hinge



DSPA-18
Door Hinge (Square)



DSPA-19
Butterfly Hinge



DSPA-20
L Joints



DSPA-21
Profile Corner Joints



DSPA-22
Profile Jointers



DSPA-23
Profile Joints



DSPA-24
Profile Joints



DSPA-25
Handle with Lock



DSPA-26
Sliding Handle



DSPA-27
Top and Bottom Pivot

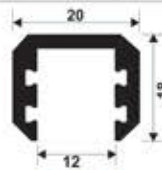

DGEF-1
For Glass Door

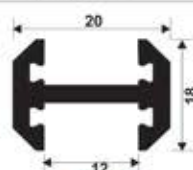

DGEF2
For Glass Door Partition

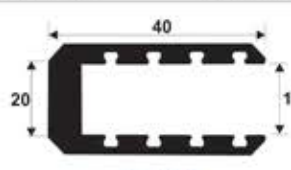

DGEF-3
For Glass Door

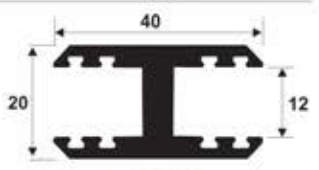

DGEF-4
For Glass Door Partition

AUTOMATIC SWING DOOR



DASD-1
Automatic Swing Door



Specification :

Suitable for door weight 200kgs.
Opening angle 70° / 115°
Suitable for door weight from 85-120kgs.
Closing Speed 100 to 400 mm/s (Adjustable).
Controller Dimension 85x124x600mm
Door Hold Time 0.5-10sec (Adjustable).
Opening Direction - Optional
Supply Voltage - AC 220V-250V, 50/60Hz
Max. Motor Power 55W
Weight - 12kg.



Advanced Operating System

High efficient and small drive torque DC brushless motor, gentle opening and closing, smooth braking, energy saving & environmental protection.

Safety

Excellent pinch performance. The door returns back automatically in case of any obstacle or resistance during closing.

Convenient

Modular & compact design, beautiful appearance, easy installation.

Reliable

New drive, high quality DC Brushless motor, gear box helical gears, wheels and high wear characteristics reasonable structural design makes it reliable, quiet operation and longer life

Compatible

Standard configuration can be integrated with variety of additional accessories as per the site requirements.

RETRO SWING DOOR



Advanced Operating System

High efficient and small drive torque DC brushless motor, gentle opening and closing, smooth braking, energy saving & environmental protection.

Safety

Excellent pinch performance. The door returns back automatically in case of any obstacle or resistance during closing.

Convenient

Modular & compact design, beautiful appearance, easy installation.

Reliable

New drive, high quality DC Brushless motor, gear box helical gears, wheels and high wear characteristics reasonable structural design makes it reliable, quiet operation and longer life

Compatible

Standard configuration can be integrated with variety of additional accessories as per the site requirements.



DRSD-1
Retro Swing Door

Specification :

Controller - High Performance Micro Controller
Suitable for door weight 200kgs.
Opening angle 90°
Suitable for door weight from 85-120kgs.
Closing Speed 100 to 400 mm/s (Adjustable).
Dimension 82x186x310mm
Door Hold Time 0.3-14sec (Adjustable).
Opening Direction - Optional
Supply Voltage - AC 220V-250V, 50/60Hz
Extensions - Safety Light Barrier, Such as Remote Control of various types of access control.



WOODEN SLIDING FOLDING SYSTEM



DWSF-1
Hinges with Intermediate Roller with
Bottom Guide Folding System



DWSF-2
End Roller & Bottom Guide



DWSF-3
Wooden to Wooden Panel
Connecting Hinges with Handle



DWSF-4
Top and Bottom Pivot for
Wooden Sliding Folding System



DWSF-1
Hinges with Handle for
Connecting two Wooden Panel

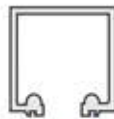

DWSF-2
Top Track (12 Feet)

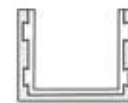

DWSF-3
Bottom Track (12 Feet)

Ordering Information for Wooden Sliding Folding System- R1-WSF-200

Code	DWSF-1	DWSF-2	DWSF-3	DWSF-4	DWSF-5
For 2 Door	1	1	-	1	Optional
For 3 Door	1	1	1	-	Optional
For 4 Door	1	2	1	1	Optional
For 5 Door	1	2	2	-	Optional
For 6 Door	1	3	2	1	Optional



Spiders Without Fin (Available In 200mm & 220mm Arm Distance)
Available in SS 316

SPIDER FITTING



DFSF-A4
Four Way Spider



DFSF-A4 B
Four Way Spider

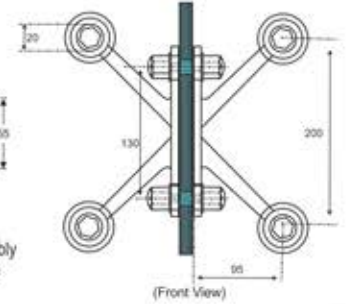
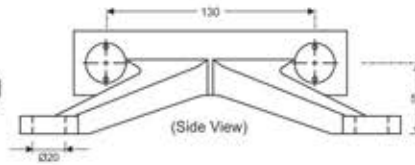

Specification
Four Way Spider with fin to suit two/four panel glass assembly
With gasket & teflon washers to prevent glass from damage
Hold glass with the help of articulated/fix routels



DFSF-A2
Two Way Spider



DFSF-A2 B
Two Way Spider

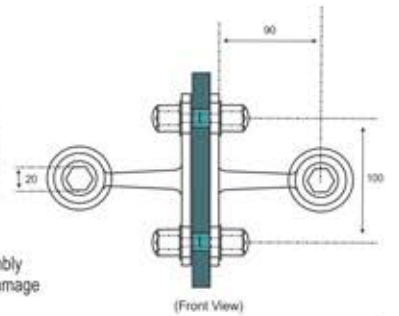
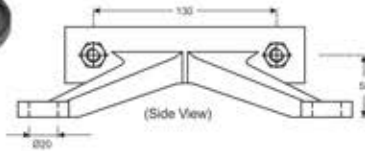

Specification
Two Way Spider with fin to suit two panel glass assembly
With gasket & teflon washers to prevent glass from damage
Hold glass with the help of articulated/fix routels



DFSF-A44
Two Way Spider (Wall Mounted)



DFSF-A44 B
Two Way Spider (Wall Mounted)

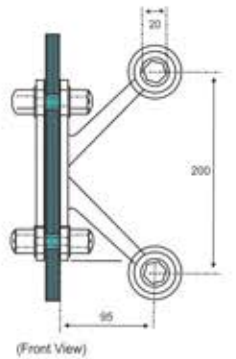
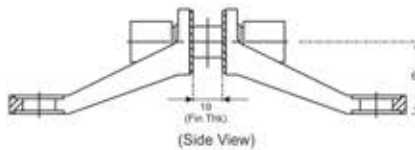

Specification
Two Way Spider with fin to suit two panel wall assembly
With gasket & teflon washers to prevent glass from damage
Hold glass with the help of articulated/fix routels



DFSF-A22
One Way Spider (Wall Mounted)



DFSF-A22 B
One Way Spider (Wall Mounted)

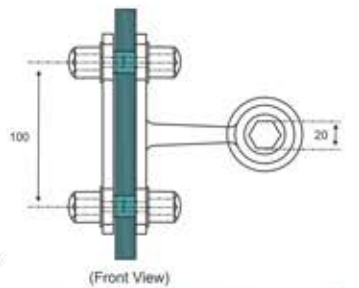
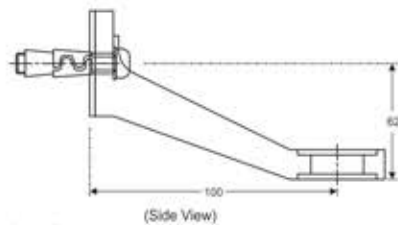

Specification
One Way Spider with fin to suit one panel wall assembly
With gasket & teflon washers to prevent glass from damage
Hold glass with the help of articulated/fix routels





DFSF-B1
One Way Spider without Fin



DFSF-B1 BM
One Way Spider without Fin

Specification
160 mm arm
One Way Spider without fin to hold the glass at one point
Material : **Stainless Steel 316 Grade**
• Hold glass with the help of articulated/fix routel.
• Designed to hold with fix structure

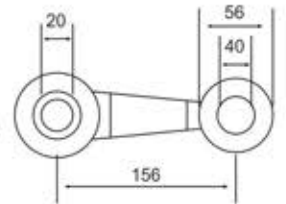

DFSF-B2 (90°)
Two Way Spider without Fin



DFSF-B2 (90°) BM
Two Way Spider without Fin

Specification
Two Way Spider without fin to hold two glass panels at 90° with fixed structure.
Material : **Stainless Steel 316 Grade**
Hold glass with the help of articulated/fix routels.
Designed to hold with fix structure

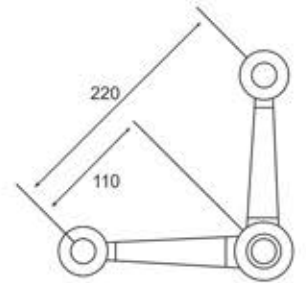

DFSF-B2 (180°)
Two Way Spider without Fin



DFSF-B2 (180°) BM
Two Way Spider without Fin

Specification
220 mm arm
Two Way Spider without fin to hold two glass panels at 180° with fixed structure.
Material : **Stainless Steel 316 Grade**
Hold glass with the help of articulated/fix routels.
Designed to hold with fix structure

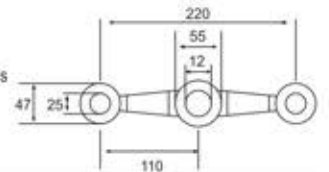

DFSF-B3 (180°)
Three Way Spider without Fin



DFSF-B3 (180°) BM
Three Way Spider without Fin

Specification
Three Way Spider without fin to hold three glass panels together with fixed structure
Material : **Stainless Steel 316 Grade**
Hold glass with the help of articulated/fix routels.
Designed to hold with fix structure

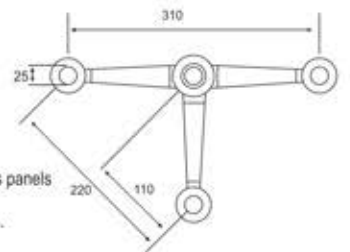

DFSF-B4
Four Way Spider without Fin



DFSF-B4 BM
Four Way Spider without Fin

Specification
Four Way Spider without fin to hold four glass panel together with fixed structure
Material : **Stainless Steel 316 Grade**
Hold glass with the help of articulated/fix routel.
Designed to hold with fix structure

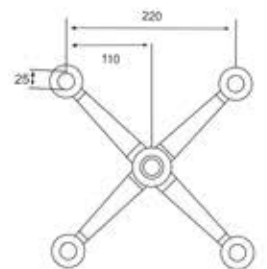

DFSF-B5
Four Way Spider without Fin for 90° corner



DFSF-B5 BM
Four Way Spider without Fin for 90° corner

Specification
Four Way Spider without fin 90° to hold four glass panel together with fixed structure
Material : **Stainless Steel 316 Grade**
Hold glass with the help of articulated/fix routel
Designed to hold with fix structure

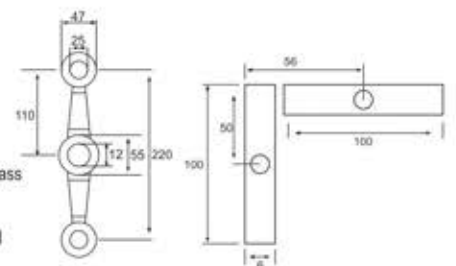



DFSP-D22
One Way Spider for Wall/Ceiling



DFSP-D22 BM
One Way Spider for Wall/Ceiling

Specification

One Way Spider with fin to suit two/four panel glass assembly
With gasket & teflon washers to prevent glass from damage
Hold glass with the help of articulated/fix routels

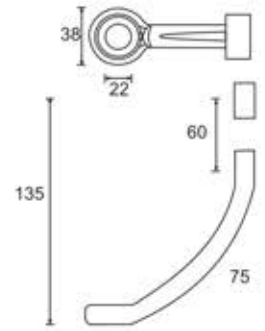

DFSP-D44
Two Way Spider 90° for Wall/Ceiling



DFSP-D44 BM
Two Way Spider 90° for Wall/Ceiling

Specification

Two Way Spider with fin to suit two panel glass assembly
With gasket & teflon washers to prevent glass from damage
Hold glass with the help of articulated/fix routels

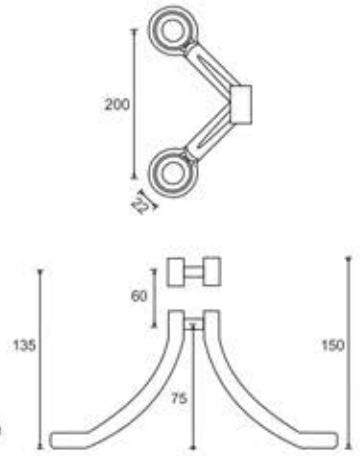

DFSP-D2
Two Way Spider 180° with Fin



DFSP-D2 BM
Two Way Spider 180° with Fin

Specification

Two Way Spider with fin to suit two panel wall assembly
With gasket & teflon washers to prevent glass from damage
Hold glass with the help of articulated/fix routels

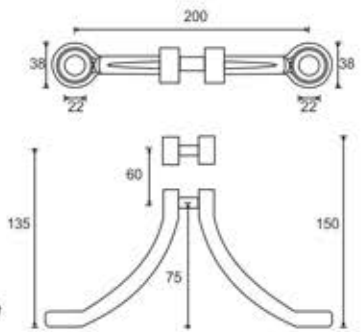

DFSP-D4
Four Way Spider with Fin



DFSP-D4 BM
Four Way Spider with Fin

Specification

Four Way Spider with fin to suit one panel wall assembly
With gasket & teflon washers to prevent glass from damage
Hold glass with the help of articulated/fix routels

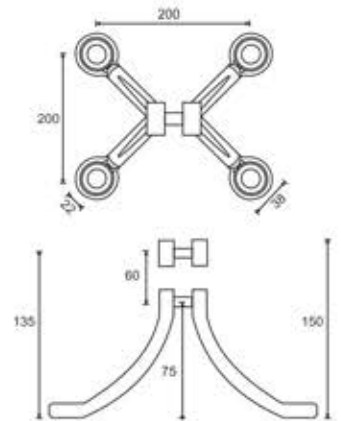



DFSP-1
One Way Spider for Wall/Ceiling



DFSP-1 BM
One Way Spider for Wall/Ceiling

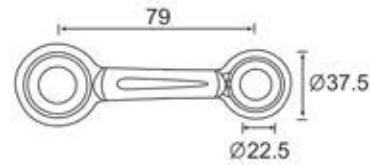

Specification
One Way Spider with fin to suit two/four panel glass assembly
With gasket & Teflon washers to prevent glass from damage
Hold glass with the help of articulated/fix routels



DFSP-2
Two Way Spider 180° with Fin



DFSP-2 BM
Two Way Spider 180° with Fin

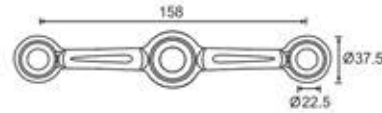

Specification
Two Way Spider with fin to suit two panel glass assembly
With gasket & Teflon washers to prevent glass from damage
Hold glass with the help of articulated/fix routels



DFSP-2A
Two Way Spider 90° for Wall/Ceiling



DFSP-2A BM
Two Way Spider 90° for Wall/Ceiling

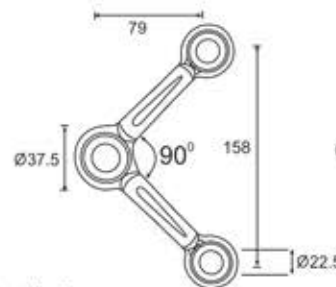

Specification
Two Way Spider with fin to suit two panel wall assembly
With gasket & Teflon washers to prevent glass from damage
Hold glass with the help of articulated/fix routels

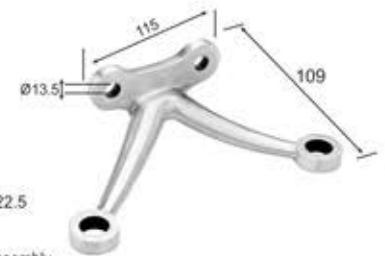

DFSP-4
Four Way Spider with Fin



DFSP-4 BM
Four Way Spider with Fin

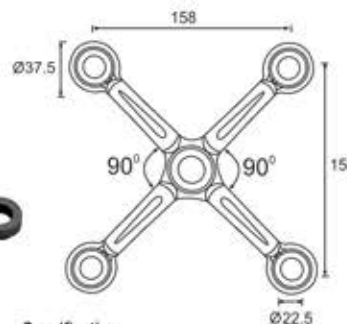

Specification
Four Way Spider with fin to suit one panel wall assembly
With gasket & Teflon washers to prevent glass from damage
Hold glass with the help of articulated/fix routels

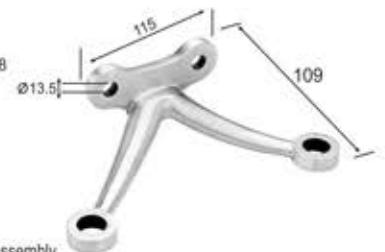



ARTICULATED ROUTELS

DORFIX



DFSP-AFB 36FL
Articulated Routel (Flat Head)



DFSP-AFB 36FL BM
Articulated Routel (Flat Head)



Specification
Articulated flat head routel to be used along with spiders to hole glass
Material : **Stainless Steel 316 Grade**
With Teflon washers to prevent glass from damage
Adjustable upto 15mm glass thickness

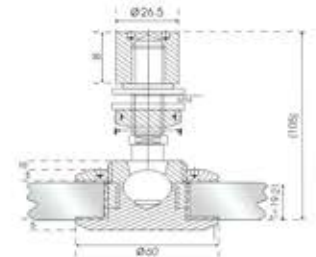

DFSP-AFB 36CS
Articulated Routel (Counter Sunk Hole)



DFSP-AFB 36CS BM
Articulated Routel (Counter Sunk Hole)

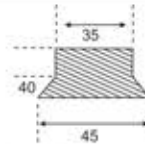

Specification
Articulated Cunter Sunk routel to be used along with spiders to hole glass
Material : **Stainless Steel 316 Grade**
With Teflon washers to prevent glass from damage
Adjustable upto 15mm glass thickness

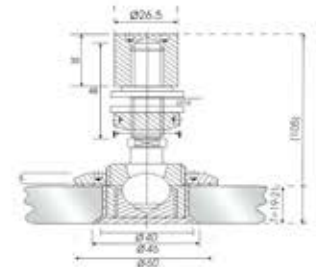

DFSP-FB FL
Fixed Routel (Flat Head)



DFSP-FB FL BM
Fixed Routel (Flat Head)



Specification
Countersunk head routel to be used along with spiders to hold glass
Material : **Stainless Steel 316 Grade**
With teflon washers to prevent glass from damage

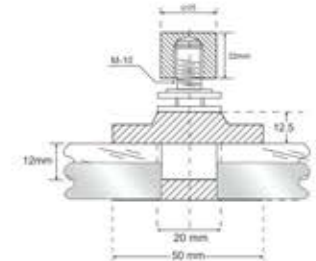

DFSP-FB CS
Fixed Routel (Counter Sunk)



DFSP-FB CS BM
Fixed Routel (Counter Sunk)

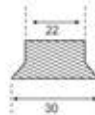

Specification
Fixed flat head routel to be used along with spiders to hold glass
Material : **Stainless Steel 316 Grade**
With Teflon washers to prevent glass from damage
Adjustable to glass thickness
Smaller in sizes

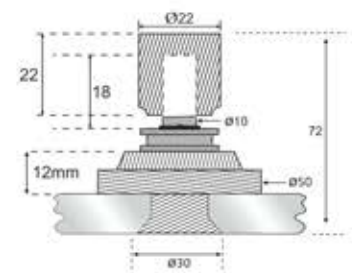

DFSP-RB (FH/CS)
Rigid Bolt (Flat Head/Counter Sunk)



DFSP-RB (FH/CS) BM
Rigid Bolt (Flat Head/Counter Sunk)

Specification
• Rigid Bolt to be used along with spiders to hole glass
• Material : **Stainless Steel 316 Grade**
• With Teflon washers to prevent glass from damage
• Adjustable upto 15mm glass thickness

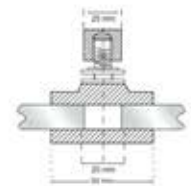

DFSP-01
Iron Assembly



DFSP-01
Iron Assembly

Specification
Fixing bolt helps to hold without fin spiders with fix structure
Material : **Stainless Steel 316 Grade**
Adjustable height for accurate fixing of spider with flat head

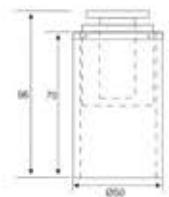

DFSP-FBM
Fixed Bolt (Mini)
SS 316/304 Satin Finish



DFSP-FBM BM
Fixed Bolt (Mini)
SS 316/304 Satin Finish



DFSP-FBM A
Fixed Bolt (Mini)
SS 316/304 Satin Finish



DFSP-FBM A BM
Fixed Bolt (Mini)
SS 316/304 Satin Finish



DFFP-200
Fin Plate 200mm



DFFP-200 BM
Fin Plate 200mm

Specification
Two point holding of fin
Finish : Satin Stainless Steel (SSS)
Material : **Stainless Steel 316 Grade**
With Teflon washers to prevent glass from damage

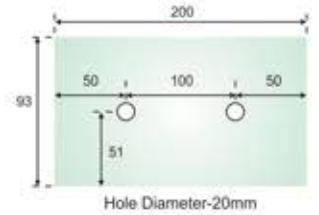

DFFP-300
Fin Plate 300mm
DFFP-350
Fin Plate 350mm



DFFP-300 BM
Fin Plate 300mm
DFFP-350 BM
Fin Plate 350mm

Specification
Three point holding of fin
Finish : Satin Stainless Steel (SSS)
Material : **Stainless Steel 316 Grade**
With Teflon washers to prevent glass from damage

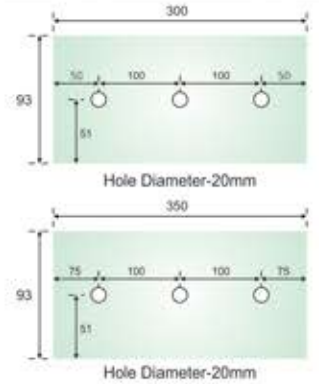

DFFP-400
Fin Plate 400mm



DFFP-400 BM
Fin Plate 400mm

Specification
Three point holding of fin
Finish : Satin Stainless Steel (SSS)
Material : **Stainless Steel 316 Grade**
With Teflon washers to prevent glass from damage

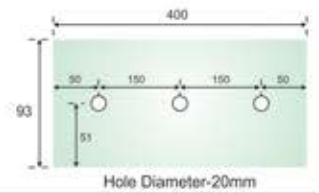

SPLICE PLATE



DFSP-200
Splice Plate 200mm



DFSP-200
Splice Plate 200mm

Specification
Two point holding with each fin part
Finish : Satin Stainless Steel (SSS)
Material : **Stainless Steel 316 Grade**
With Teflon washers to prevent glass from damage

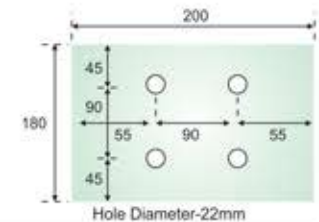

DFSP-250
Splice Plate 250mm
DFSP-300
Splice Plate 300mm



DFSP-250 BM
Splice Plate 250mm
DFSP-300 BM
Splice Plate 300mm

Specification
Three point holding with each fin part
Finish : Satin Stainless Steel (SSS)
Material : **Stainless Steel 316 Grade**
With Teflon washers to prevent glass from damage

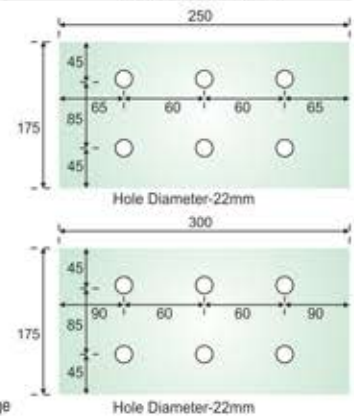

DFSP-350
Splice Plate 350mm



DFSP-350 BM
Splice Plate 350mm

Specification
Three point holding with each fin part
Finish : Satin Stainless Steel (SSS)
Material : **Stainless Steel 316 Grade**
With Teflon washers to prevent glass from damage

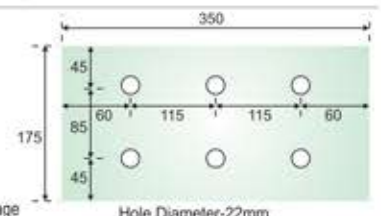



DFDC-1001
Door Closer (Nano)
Door Weight : 40-45 kg

- Specification**
- Applicable door width : 500-1000mm
 - Applicable door weight **up to 40-45kg**
 - Adjustable section of closing speed 180°-20°
 - Adjustable section of latching speed 20°-0°
 - The door closer is suitable for installing in various doors, such as wooden door, metal door, etc
 - The door closer can be chosen to stop or unstop at will.
 - Continuous adjustment of closing and latching speed: the fast speed can be adjusted to within 3 seconds from 90 degree, slowness close can



DFDC-1002
Door Closer (Classic)
Door Weight : 60-65 kg

- Specification**
- Applicable door width : 600-1200mm
 - Applicable door weight **up to 60-65kg**
 - Adjustable section of closing speed 180°-20°
 - Adjustable section of latching speed 20°-0°
 - The door closer is suitable for installing in various doors, such as wooden door, metal door, etc
 - The door closer can be chosen to stop or unstop at will
 - Continuous adjustment of closing and latching speed: the fast speed can be adjusted to within 3 seconds from 90 degree, slowness close can reach to 60 seconds or more



DFDC-1003
Door Closer (Hut)
Door Weight : 40-65 kg

- Specification**
- Applicable door width : 800-1100mm
 - Applicable door weight **up to 40-65kg**
 - Adjustable section of closing speed 180°-20°
 - Adjustable section of latching speed 20°-0°
 - The door closer is suitable for installing in various doors, such as wooden door, metal door, etc
 - The door closer can be chosen to stop or unstop at will
 - Continuous adjustment of closing and latching speed: the fast speed can be adjusted to within 3 seconds from 90 degree, slowness close can



DFDC-1004
Door Closer (Pelmet)
Door Weight : 35-65 kg

- Specification**
- Applicable door width : 500-1200mm
 - Applicable door weight **up to 30-65kg**
 - With pelmet arm for hold open function
 - Separate stainless steel plate for attractive look
 - Adjustable section of closing speed 180°-20°
 - Adjustable section of latching speed 20°-0°
 - The door closer is suitable for installing in various doors, such as wooden door, metal door, etc
 - The installation modes of vertical, parallel and slide-rail type all can be chosen at will
 - Continuous adjustment of closing and latching speed: the fast speed can be adjusted to within 3 seconds from 90 degree, slowness close can reach to 60 seconds or more



DFDC-1005
Door Closer (Concealed)
Door Weight : 30-65 kg

- Specification**
- Applicable door width : 500-1200mm
 - Applicable door weight **up to 30-65kg**
 - With pelmet arm for hold open function
 - Fit into inside wooden, metal doors.
 - Adjustable section of closing speed 180°-20°
 - Adjustable section of latching speed 20°-0°
 - The door closer is suitable for installing in various doors, such as wooden door, metal door, etc
 - The installation modes of vertical, parallel and slide-rail type all can be chosen at will
 - Continuous adjustment of closing and latching speed: the fast speed can be adjusted to within 3 seconds from 90 degree, slowness close can reach to 60 seconds or more





DFLK-1
Double Door Lock (Only Key)

Specification
 Material : Stainless steel
 Finish : Satin stainless steel
 One side key-Lock from outside only
 Suitable for 10/12mm Glass
 Glass preparation/cutout not required
 With gasket to prevent glass from damage
 With three bass computer key
 Suitable for glass to glass



DFLK-1 BM
Double Door Lock (Only Key)



DFLK-1 G
Double Door Lock (Only Key)



DFLK-1 RG
Double Door Lock (Only Key)



DFLK-2
Single Door Lock (Only Key)

Specification
 Material : Stainless steel
 Finish : Satin stainless steel
 One side key-Lock from outside only
 Suitable for 10/12mm Glass
 Glass preparation/cutout not required
 With gasket to prevent glass from damage
 With three bass computer key
 Suitable for glass to wall/fix structure



DFLK-2 BM
Single Door Lock (Only Key)



DFLK-2 G
Single Door Lock (Only Key)



DFLK-2 RG
Single Door Lock (Only Key)



DFLK-3
Double Door Lock (Key & Knob)

Specification
 Material : Stainless steel
 Finish : Satin stainless steel
 One side key-Lock from outside only
 Suitable for 10/12mm Glass
 Glass preparation/cutout not required
 With gasket to prevent glass from damage
 With three bass computer key
 Suitable for glass to glass



DFLK-3 BM
Double Door Lock (Key & Knob)



DFLK-3 G
Double Door Lock (Key & Knob)



DFLK-3 RG
Double Door Lock (Key & Knob)



DFLK-4
Single Door Lock (Key & Knob)

Specification
 Material : Stainless steel
 Finish : Satin stainless steel
 One side key-Lock from outside only
 Suitable for 10/12mm Glass
 Glass preparation/cutout not required
 With gasket to prevent glass from damage
 With three bass computer key
 Suitable for glass to wall/fix structure



DFLK-4 BM
Single Door Lock (Key & Knob)



DFLK-4 G
Single Door Lock (Key & Knob)



DFLK-4 RG
Single Door Lock (Key & Knob)



DFLK-5
Double Door Lock (Only Key)

Specification
 Material : Stainless steel
 Finish : Satin stainless steel
 One side key-Lock from outside only
 Suitable for 10/12mm Glass
 Glass preparation/cutout not required
 With gasket to prevent glass from damage
 With three bass computer key
 Suitable for glass to glass



DFLK-6
Single Door Lock (Only Key)

Specification
 Material : Stainless steel
 Finish : Satin stainless steel
 One side key-Lock from outside only
 Suitable for 10/12mm Glass
 Glass preparation/cutout not required
 With gasket to prevent glass from damage
 With three bass computer key
 Suitable for glass to wall/fix structure



DFLK-7
Double Door Lock (Key & Knob)

Specification
 Material : Stainless steel
 Finish : Satin stainless steel
 One side key/one side knob
 Suitable for 10/12mm Glass
 Glass preparation/cutout not required
 With gasket to prevent glass from damage
 With three bass computer key
 Suitable for glass to glass



DFLK-8
Single Door Lock (Key & Knob)

Specification
 Material : Stainless steel
 Finish : Satin stainless steel
 One side key/one side knob
 Suitable for 10/12mm Glass
 Glass preparation/cutout not required
 With gasket to prevent glass from damage
 With three bass computer key
 Suitable for glass to wall/fix structure



DFLK-9 (Slot Type)
Mini Double Door Lock (Key & Knob)

Specification
 • Material : Stainless steel
 • Finish : Satin stainless steel
 • One side knob only
 • Suitable for 10/12mm Glass
 • Glass preparation/cutout not required
 • With gasket to prevent glass from damage
 • With three bass computer key
 • Suitable for glass to glass



DFLK-10 (Slot Type)
Mini Single Door Lock (Key & Knob)

Specification
 • Material : Stainless steel
 • Finish : Satin stainless steel
 • One side knob only
 • Suitable for 10/12mm Glass
 • Glass preparation/cutout not required
 • With gasket to prevent glass from damage
 • With three bass computer key
 • Suitable for glass to wall/fix structure



LOCKS WITHOUT CUTOUT

Also Available in :
Black Matt Gold Rose Gold



DFLK-11 (Pin Type)
Mini Double Door Lock (Key & Knob)

Specification
Material : Stainless steel
Finish : Satin stainless steel
One side knob only
Suitable for 10/12mm Glass
Glass preparation/cutout not required
With gasket to prevent glass from damage
With three bass computer key
Suitable for glass to glass



DFLK-12 (Pin Type)
Mini Single Door Lock (Key & Knob)

Specification
Material : Stainless steel
Finish : Satin stainless steel
One side knob only
Suitable for 10/12mm Glass
Glass preparation/cutout not required
With gasket to prevent glass from damage
With three bass computer key
Suitable for glass to wall/fix structure



DFLK-13
Double Door Lock (Only Knob)

Specification
Material : Stainless steel
Finish : Satin stainless steel
One Side Knob Only
Suitable for 10/12mm Glass
Glass preparation/cutout not required
With gasket to prevent glass from damage
With three bass computer key
Suitable for glass to glass



DFLK-13 BM
Double Door Lock (Only Knob)



DFLK-13 G
Double Door Lock (Only Knob)



DFLK-13 RG
Double Door Lock (Only Knob)



DFLK-14
Single Door Lock (Only Knob)

Specification One Side Knob Only
Material : Stainless steel
Finish : Satin stainless steel
One side knob only
Suitable for 10/12mm Glass
Glass preparation/cutout not required
With gasket to prevent glass from damage
With three bass computer key
Suitable for glass to wall/fix structure



DFLK-14 BM
Single Door Lock (Only Knob)



DFLK-14 G
Single Door Lock (Only Knob)



DFLK-14 RG
Single Door Lock (Only Knob)



DFLK-15
Double Door Lock

Specification
Material : Stainless steel
Finish : Satin stainless steel
One Side Knob Only
Suitable for 10/12mm Glass
Glass preparation/cutout not required
With gasket to prevent glass from damage
With three bass computer key
Suitable for glass to glass



DFLK-16
Single Door Lock

Specification
Material : Stainless steel
Finish : Satin stainless steel
One Side Knob Only
Suitable for 10/12mm Glass
Glass preparation/cutout not required
With gasket to prevent glass from damage
With three bass computer key
Suitable for glass to wall/fix structure



DFLK-17
Double Door Lock (Only Knob)

Specification
Material : Stainless steel
Finish : Satin stainless steel
One Side Knob Only
Suitable for 10/12mm Glass
Glass preparation/cutout not required
With gasket to prevent glass from damage
With three bass computer key
Suitable for glass to glass



DFLK-18
Single Door Lock (Only Knob)

Specification
Material : Stainless steel
Finish : Satin stainless steel
One Side Knob Only
Suitable for 10/12mm Glass
Glass preparation/cutout not required
With gasket to prevent glass from damage
With three bass computer key
Suitable for glass to wall/fix structure



DFLK-19
Double Door Lock (Key & Knob)

Specification
Material : Stainless steel
Finish : Satin stainless steel
One side key/one side knob
Suitable for 10/12mm Glass
Glass preparation/cutout not required
With gasket to prevent glass from damage
With three bass computer key
Suitable for glass to glass



DFLK-20
Single Door Lock (Key & Knob)

Specification
Material : Stainless steel
Finish : Satin stainless steel
One side key/one side knob
Suitable for 10/12mm Glass
Glass preparation/cutout not required
With gasket to prevent glass from damage
With three bass computer key
Suitable for glass to wall/fix structure



LOCKS WITHOUT CUTOUT



DFDL-03
Door Lock (Key & Knob)

Specification
Material : Stainless steel 304
Finish : Satin
One side key/one side knob
Suitable for 10/18mm Tempered Glass
Glass preparation/cutout not required
With gasket to prevent glass from damage
With Four brass computer key
Brass Cylinder
Suitable for glass to wall/fix structure

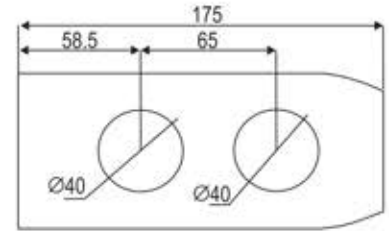

DFDL-04
Door Lock (Key & Knob)

Specification
Material : Stainless steel 304
Finish : Satin
One side key/one side knob
Suitable for 10/18mm Tempered Glass
Glass preparation/cutout not required
With gasket to prevent glass from damage
With Four brass computer key
Brass Cylinder
Suitable for glass to glass

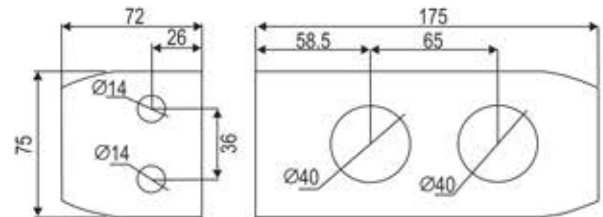

DFDL-13A+13C
Door Lock (Key & Knob)

Specification
Material : Stainless steel 304
Finish : Satin
One side key/one side knob
Suitable for 10/18mm Tempered Glass
Glass preparation/cutout not required
With gasket to prevent glass from damage
With Four brass computer key
Brass Cylinder
Suitable for glass to wall/fix structure

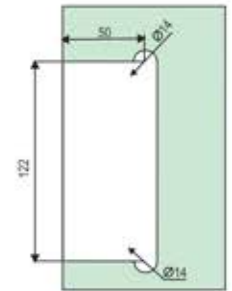

DFDL-13A+13B
Door Lock (Key & Knob)

Specification
Material : Stainless steel 304
Finish : Satin
One side key/one side knob
Suitable for 10/18mm Tempered Glass
Glass preparation/cutout not required
With gasket to prevent glass from damage
With Four brass computer key
Brass Cylinder
Suitable for glass to glass

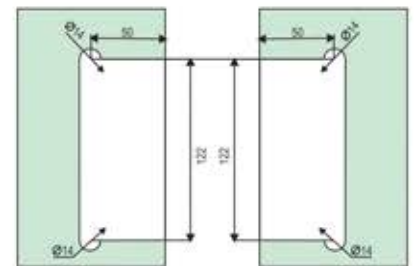

DFDL-23
Door Lock (Key & Knob)

Specification
Material : Zinc Alloy
Finish : Satin
One side key/one side knob
Suitable for 10/18mm Tempered Glass
Glass preparation/cutout not required
With gasket to prevent glass from damage
With Four brass computer key
Brass Cylinder
Suitable for glass to wall/fix structure

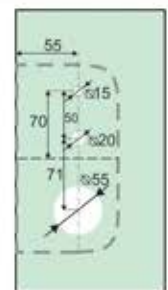

DFDL-24
Door Lock (Key & Knob)

Specification
Material : Zinc Alloy
Finish : Satin
One side key/one side knob
Suitable for 10/18mm Tempered Glass
Glass preparation/cutout not required
With gasket to prevent glass from damage
With Four brass computer key
Brass Cylinder
Suitable for glass to glass

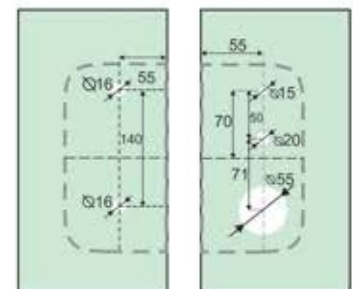



DORFIX

BIOMETRIC SMARTER SERIES LOCKS

The Safest, Most Reliable and Secure Smart Locks



DFDL-100
Intelligent Glass Door Lock



DFDL-100 H
Intelligent Glass Sliding Door Lock with WIFI



DFDL-200 BRONZE
6-in-One Intelligent Mortise Lock with Blue Tooth



WIFI Gateway



DFDL-300 GOLD
Hotel Door Lock



DFDL-300 MATT
Hotel Door Lock



DFDL-200 BLACK
6-in-One Intelligent Mortise Lock



DFDL-600
7-in-One Intelligent Main Door Lock with WIFI



DFDL-400
Pad Lock



DFDL-700
Waterproof Main Door Rim



DFDL-500
Drawer Lock



DFDL-800
Face and Finger Print Attendance Machine



DFDL-900
Door Lock with Video Visual Real Time Camera
WIFI Biometric Fingerprint Digital Keyless



DFDHL-55 Size : 35x1500mm
DFDHL-55 BM Size : 35x1500mm
DFDHL-55 G Size : 35x1500mm
DFDHL-55 RG Size : 235x1500mm

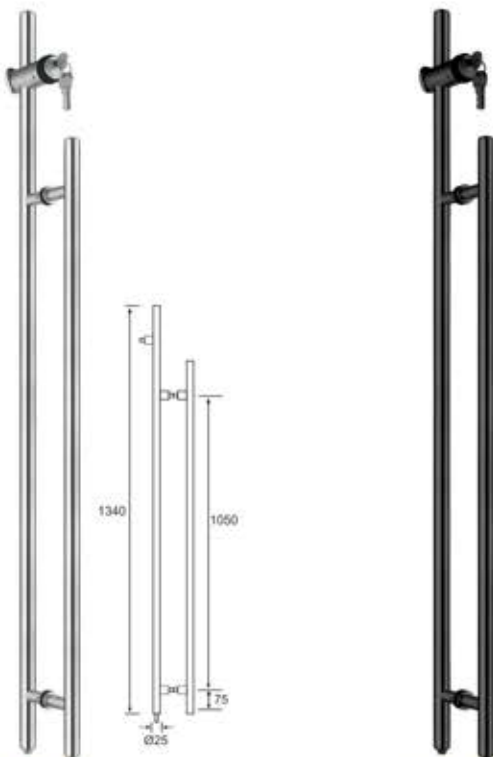

DFDHL-66 Size : 25x1340mm
DFDHL-55 BM Size : 25x1340mm

Specification
 Operation One side key/one side Knob
 Finish : Satin stainless steel (SSS)
 Material : Stainless steel 304 grade
 For back to back installation
 With gasket to prevent glass from damage
 With grub screw to give neat look
All sizes in mm

* Refer to original product for cutout and hole to hole distance.





* Refer to original product for cutout and hole to hole distance

DOOR HANDLES

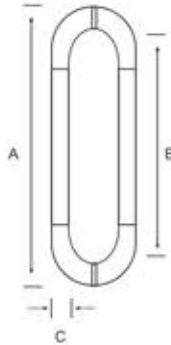

Overall Length	C to C Hole	Diameter
175	150	25
225	200	25
330	305	25
480	455	25
480	450	32

- Specification**
- Finish : Satin + Polish stainless steel / Full Satin
 - Material : Stainless steel
 - For back to back installation
 - With gasket to prevent glass from damage
 - With grub screw to give neat look
 - All sizes in mm

DFDH-11



Overall Length	C to C Hole	Diameter
327	302	25x25
480	450	30x30
600	570	30x30

- Specification**
- Finish : Satin + Polish stainless steel
 - Material : Stainless steel
 - For back to back installation
 - With gasket to prevent glass from damage
 - With grub screw to give neat look
 - All sizes in mm

DFDH-44

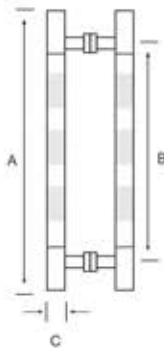

Overall Length	C to C Hole	Diameter
250	200	25
300	250	25
350	300	25
457	302	32
600	450	38
800	600	38
900	600	38
900	700	38
1200	900	38
1500	1200	38

- Specification**
- Finish : Satin + Polish stainless steel / Full Satin
 - Material : Stainless steel
 - For back to back installation
 - With gasket to prevent glass from damage
 - With grub screw to give neat look
 - All sizes in mm

DFDH-55



Overall Length	C to C Hole	Diameter
350	250	25
457	302	32
600	450	32

- Specification**
- Finish : Satin + Polish stainless steel
 - Material : Stainless steel
 - For back to back installation
 - With gasket to prevent glass from damage
 - With grub screw to give neat look
 - All sizes in mm

DFDH-77



DFDH-55E (CP+Matt)

DFDH-55G (Gold)

DFDH-55RG (Rose Gold)

DFDH-55B (Black Matt)

Overall Length	C to C Hole	Diameter
457	302	32

Overall Length	C to C Hole	Diameter
457	302	32

Overall Length	C to C Hole	Diameter
457	302	32

Overall Length	C to C Hole	Diameter
457	302	32

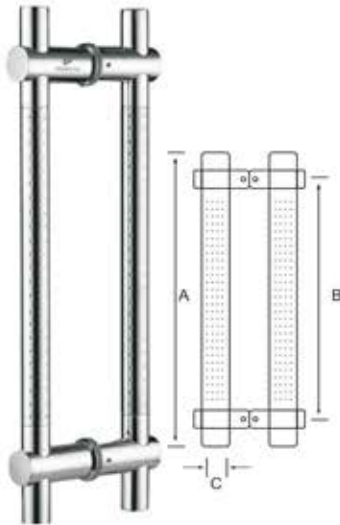

Overall Length	C to C Hole	Diameter
350	200	25
457	302	32
600	450	32
900	600	32
1200	900	32

Specification

- Finish : Satin + Polish stainless steel
- Material : Stainless steel
- For back to back installation
- With gasket to prevent glass from damage
- With grub screw to give neat look
- All sizes in mm

DFDH-55 (Adjustable)



Overall Length	C to C Hole	Diameter
450	302	25x45
600	455	25x45

Specification

- Finish : Wood/ Polish Stainless Steel (TW/PSS)
- Material : Stainless steel/ Teak Wood
- For back to back installation
- With gasket to prevent glass from damage
- With grub screw to give neat look
- All sizes in mm

DFDH-WSS-301



Overall Length	C to C Hole	Diameter
457	302	38

Specification

- Finish : Satin + Polish stainless steel
- Material : Stainless steel
- For back to back installation
- With gasket to prevent glass from damage
- With grub screw to give neat look
- All sizes in mm

DFDH-66



Overall Length	C to C Hole	Diameter
500	302	38
850	455	38

Specification

- Finish : Wood/ Polish Stainless Steel (TW/PSS)
- Material : Stainless steel/ Teak Wood
- For back to back installation
- With gasket to prevent glass from damage
- With grub screw to give neat look
- All sizes in mm

DFDH-WSS-303

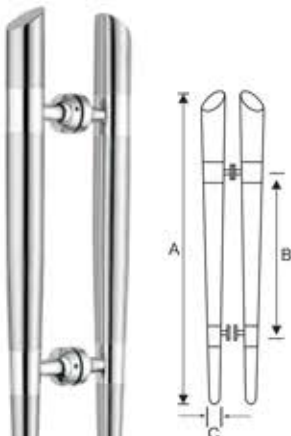

Overall Length	C to C Hole	Diameter
457	302	38
600	450	38

Specification

- Finish : Satin + Polish stainless steel / Full Satin
- Material : Stainless steel
- For back to back installation
- With gasket to prevent glass from damage
- With grub screw to give neat look
- All sizes in mm

DFDH-99

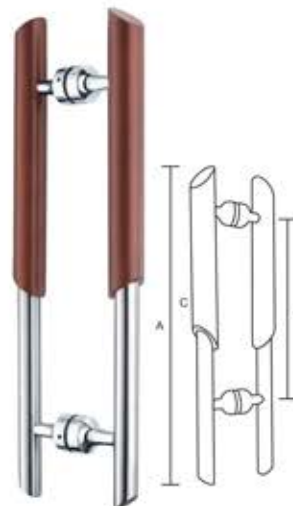

Overall Length	C to C Hole	Diameter
450	302	38x25
600	455	38x25

Specification

- Finish : Wood/ Polish Stainless Steel (TW/PSS)
- Material : Stainless steel/ Teak Wood
- For back to back installation
- With gasket to prevent glass from damage
- With grub screw to give neat look
- All sizes in mm

DFDH-WSS-302



DOOR HANDLES

DORFIX

* Refer to original product for cutout and hole to hole distance

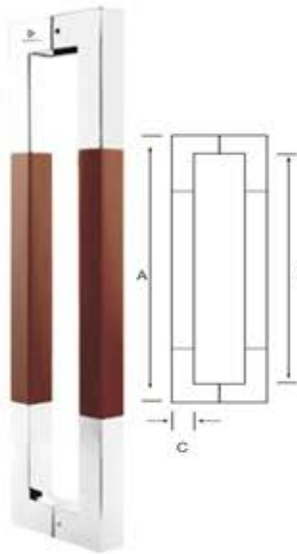

Overall Length	C to C Hole	Diameter
327	302	25x25
480	450	30x30
600	570	30x30

- Specification**
- Finish : Wood/ Polish Stainless Steel (TW/PSS)
 - Material : Stainless steel/ Teak Wood
 - For back to back installation
 - With gasket to prevent glass from damage
 - With grub screw to give neat look
 - All sizes in mm

DFDH-WSS-304

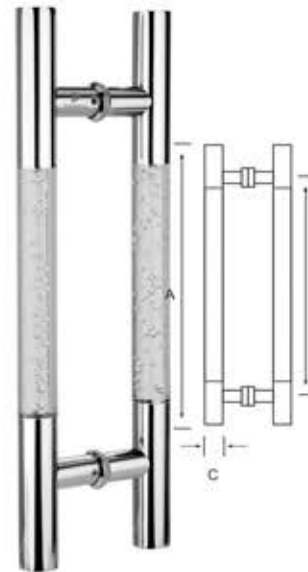

Overall Length	C to C Hole	Diameter
457	302	38
600	450	38

- Specification**
- Finish : Satin + Polish stainless steel / Full Satin
 - Material : Stainless steel / Crystal
 - For back to back installation
 - With gasket to prevent glass from damage
 - With grub screw to give neat look
 - All sizes in mm

DFDH-309 (Crystal)

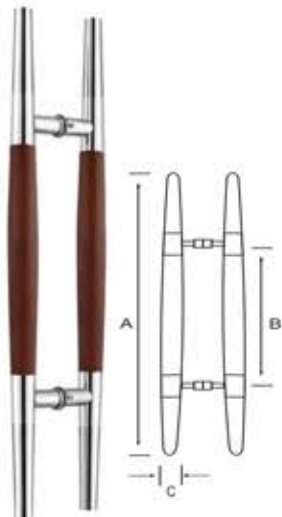

Overall Length	C to C Hole	Diameter
450	302	32

- Specification**
- Finish : Wood/ Polish Stainless Steel (TW/PSS)
 - Material : Stainless steel/ Teak Wood
 - For back to back installation
 - With gasket to prevent glass from damage
 - With grub screw to give neat look
 - All sizes in mm

DFDH-WSS-308

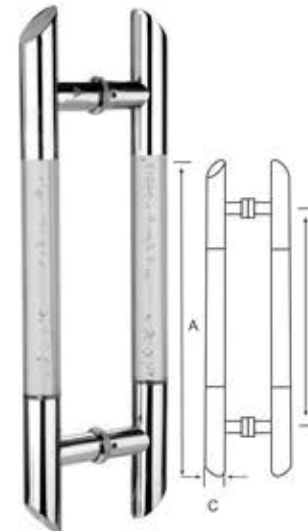

Overall Length	C to C Hole	Diameter
457	302	38
600	450	38

- Specification**
- Finish : Satin + Polish stainless steel
 - Material : Stainless steel / Crystal
 - For back to back installation
 - With gasket to prevent glass from damage
 - With grub screw to give neat look
 - All sizes in mm

DFDH-310 (Crystal)

C to C : Centre to Centre Hole

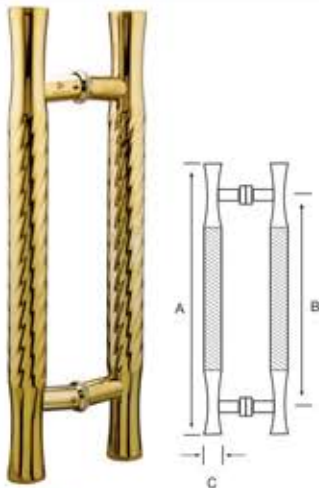

DFDH-311

Overall Length	C to C Hole	Diameter
600	450	38

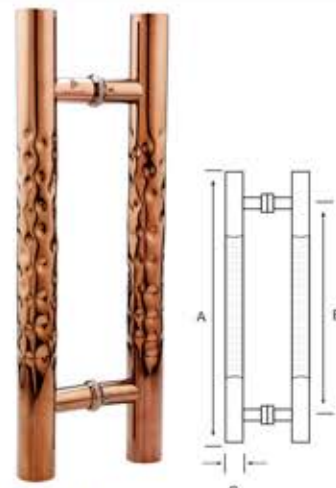

DFDH-312

Overall Length	C to C Hole	Diameter
450	302	38

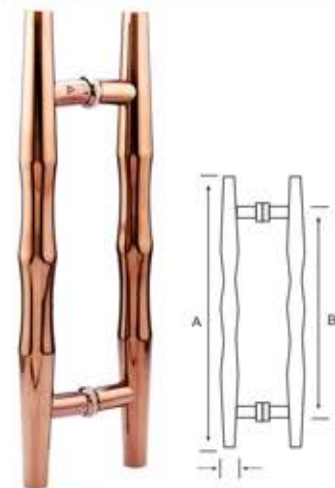

DFDH-313

Overall Length	C to C Hole	Diameter
450	302	38

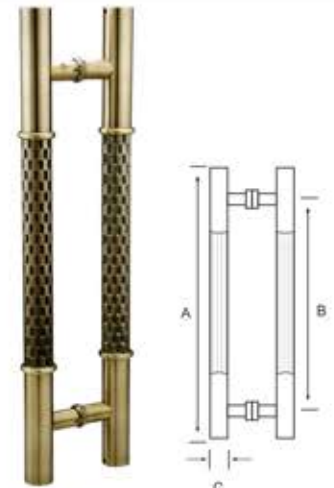

DFDH-314

Overall Length	C to C Hole	Diameter
457	302	38

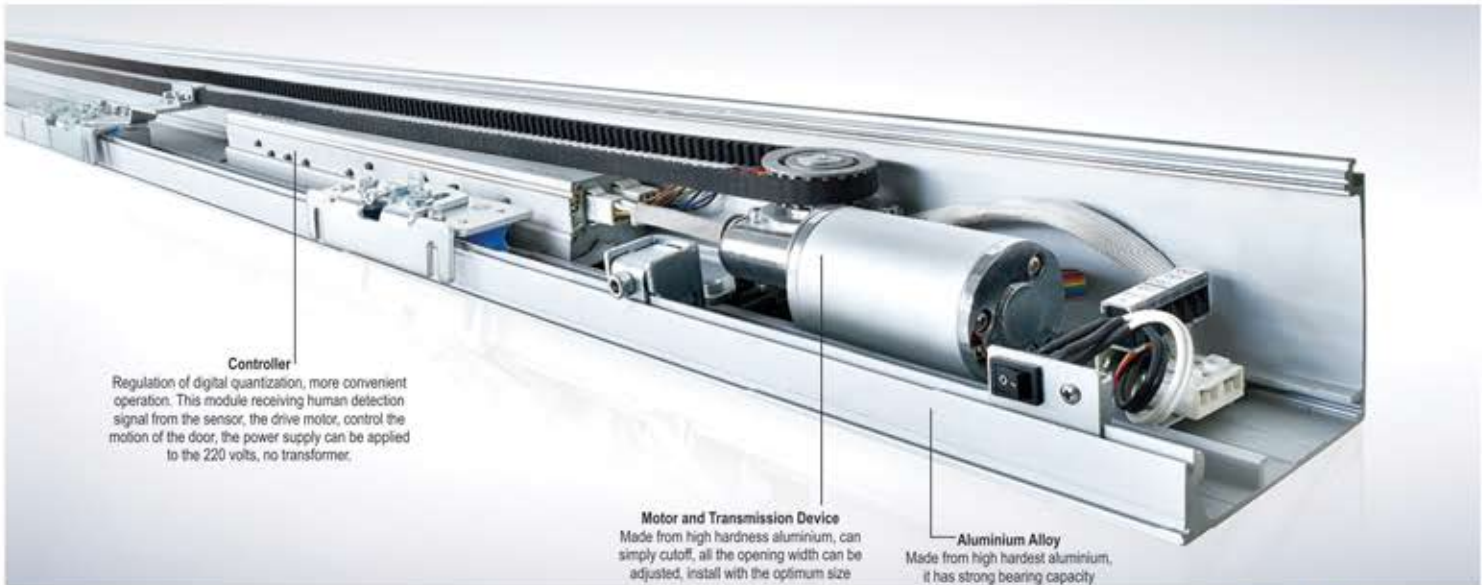

Controller
Regulation of digital quantization, more convenient operation. This module receiving human detection signal from the sensor, the drive motor, control the motion of the door, the power supply can be applied to the 220 volts, no transformer.

Motor and Transmission Device
Made from high hardness aluminium, can simply cutoff, all the opening width can be adjusted, install with the optimum size

Aluminium Alloy
Made from high hardest aluminium, it has strong bearing capacity

DFASD-22
Automatic Sensor Door



Sensor

Technical specifications

Model	R1-HD-150	
Door leaf	Single leaf	Double leaves
Weight of door leaf	Max. 150 kg	Max. 2x120kg
Width of door leaf	DW=750-1600mm	DW=650-1250mm
Width of door opening	W=1450-3100 mm	W=2500-5000 mm
Method of Installation	Surface Installation	
Supply power voltage	AC 220V 1 0%, 50-60 Hz	
Opening Speed	150°460mm/s (adjustable)	
Closing Speed	130°460mm/s (adjustable)	
Door hold-open time	0-8s (adjustable)	
Manual open/close force	< 40 N	< 50 N
Motor	DC 24 V, 60~70W(DC, brushless)	
Working Environment temperature	-20°C~50°C	

Parts List

	Fitting	Quantity
Standard	Track	1 Pc (4.2m)
	Controller	1 Pc
	Motor	1 Pc
	Power Switch	1 Pc
	Toothed Belt	1 Pc (7m)
	Belt Connection	1 Set
	Remote Control	2 Pc
	Tension Wheel	1 Pc
	Sensor	2 Pc
	Stopper	2 Pc
	Hanger (1 mtr.)	2 Pc
	Safety Beam	1 Pc

Features and advantages

- Intelligent control system.
- Drive equipment with low noise.
- Advanced brushless motor and worm wheel reducer are integrated.
- Special self-locking function without any addition components.
- With different triggered opening modes.
- Double door interlock function.
- Optional power supply backup to ensure the normal operation.
- When door is closed, it shall be locked and kept closed.
- Apply to doors for garage, usage of anti-radiation for hospitals, warehouses, science and technology factories, barrier-free space, commercial building, shopping mall, etc.
- Easy installation & low maintenance.
- Track size : 4200mm/6400mm.

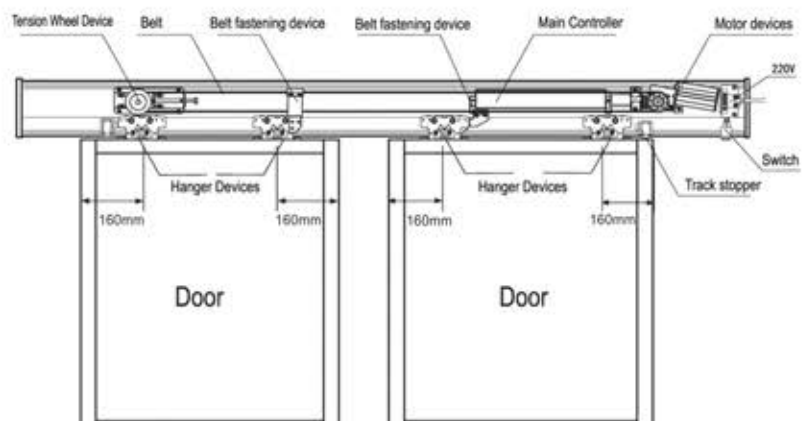



SHELF SUPPORT BUTTONS & BRACKETS

DFSSB-6 Material : Brass / Zinc Round	DFSSB-6 BM Material : Brass / Zinc Round	DFSSB-6 G Material : Brass / Zinc Round	DFSSB-6 RG Material : Brass / Zinc Round	DFSSB-10 Material : Brass / Zinc Double (H)	DFSSB-10 BM Material : Brass / Zinc Double (H)	DFSSB-10 G Material : Brass / Zinc Double (H)	DFSSB-10 RG Material : Brass / Zinc Double (H)
DFSSB-1 Material : Zinc	DFSSB-2 Material : SS	DFSSB-3 Material : SS (H) L Button	DFSSB-4 Material : Brass / Zinc Single	DFSSB-5 Material : Brass / Aluminum Shoe	DFSSB-7 Material : Zinc Pan	DFSSB-8 Material : Brass / Zinc Double	
DFSSB-9 Material : Brass / Aluminum Double Vacuum (H)	DFSSB-11 Material : Brass / Zinc Pyramid	DFSSB-12 Material : Brass / Zinc Rectangle	DFSSB-13 Material : Brass / Zinc Square Bat	DFSSB-14 Material : Unbreakable Acrylic Button	DFSSB-15 Material : Unbreakable Acrylic Button		

SHELF HOLDING BRACKETS

DFS HB-2 Material : Brass Finish : Chrome / Matt D Bracket	DFS HB-2 Material : Brass Finish : Chrome / Matt D Bracket	DFS HB-2 Material : Brass Finish : Chrome / Matt D Bracket	DFS HB-2 Material : Brass Finish : Chrome / Matt D Bracket	DFS HB-2 Material : Brass Finish : Chrome / Matt D Bracket	DFS HB-2 Material : Brass Finish : Chrome / Matt D Bracket
DFS HB-1 Material : SS Finish : Chrome / Matt D Bracket	DFS HB-3 Material : Brass Finish : Chrome / Matt Folding Bracket	DFS HB-4 Material : SS Finish : Chrome / Matt Folding Bracket	DFS HB-5 Material : Zinc / Brass Finish : Chrome / Matt Rectangle Bracket	DFS HB-6 Material : PVC Finish : White / Clear Corner Bracket	DFS HB-6 Material : PVC Finish : White / Clear Corner Bracket



SHELF HOLDING 'F' BRACKETS

DFFB-1 Material : Cast Iron Finish : Chrome / Matt F Bracket	DFFB-2 Material : SS Finish : Chrome / Matt Sheet (Patti) Bracket	DFFB-3 Material : Powder Coated Iron Finish : Silver / Brown/ Sand Black Square P/C Bracket	
DFFB-4 Material : SS Finish : Chrome / Matt Square Bracket	DFFB-4 BM Material : SS Finish : Chrome / Matt Square Bracket	DFFB-4 G Material : SS Finish : Chrome / Matt Square Bracket	DFFB-4 RG Material : SS Finish : Chrome / Matt Square Bracket



DFFB-5
Material : Brass
Finish : Chrome / Matt
F Bracket



DFFB-7 (Adjustable)
Material : SS
Finish : Chrome / Matt
Square Bracket



DFFB-8
Material : SS
Finish : Chrome / Matt
A Bracket



DFFB-9
Material : SS
Finish : Chrome / Matt
SL Sheet (Patti) Bracket



DFFB-10
Material : Brass + SS
Finish : Chrome / Matt
SL Rod Bracket

SHELF HOLDING CHANNEL & BRACKET



DFFB-11
Material : Powder Coated Iron
Finish : Brown
Folding Bracket



Bracket
Material : M/S (CP Finish)



Bracket
Material : Steel
Finish : Matt / Chrome



Channel 6 / 7 Ft.
Material : Steel / Iron
Finish : Matt / Chrome

MIRROR CAPS



DFMC-1
Material : SS (304)/ Brass
Finish : Chrome/ Matt
Round Plain



DFMC-1 BM
Material : SS (304)/ Brass
Finish : Black Matt
Round Plain



DFMC-1 G
Material : SS (304)/ Brass
Finish : Gold
Round Plain



DFMC-1 RG
Material : SS (304)/ Brass
Finish : Rose Gold
Round Plain



DFMC-2
Material : SS (304)/ Brass
Finish : Chrome/ Matt
Pyramid



DFMC-3
Material : SS (304)/ Brass
Finish : Chrome/ Matt
Swastika



DFMC-4
Material : Brass
Finish : Chrome
Crystal



DFMC-5
Material : Brass
Finish : Chrome/ Matt
Doom

MIRROR BRACKETS



DFMB-1
Material : Brass
Finish : Chrome + Matt



DFMB-2
Material : Brass
Finish : Chrome + Matt
Cut



DFMB-3
Material : Brass
Finish : Chrome + Matt
Full



DFMB-4
Material : Brass
Finish : Chrome
Crystal Cut



DFMB-5
Material : Brass
Finish : Chrome
Crystal Full



DFMB-6
Material : Brass
Finish : Chrome
Square Crystal Cut



DFMB-7
Material : Brass
Finish : Chrome
Square Crystal Full

SPACERS



DFSP-1
Material : SS
Finish : Matt
Plain



DFSP-1 BM
Material : SS
Finish : Matt
Plain



DFSP-1 G
Material : SS
Finish : Matt
Plain



DFSP-1 RG
Material : SS
Finish : Matt
Plain



DFSP-2
(Hollow Spacer)
Available in all sizes



DFSP-3
Material : SS/Aluminium
Finish : Chrome
Crystal



DFSP-4
Material : SS
Finish : Chrome
Male



DFSP-5
Material : SS
Finish : Chrome
Doom Nut

GLASS PIVOTS



DFSP-6
Material : SS
Finish : Chrome + Matt
Washer



DFSP-7
Material : SS
Finish : Chrome + Matt
Male Female



DFGP-1
Material : Brass
Finish : Chrome + Matt
Pivot



DFGP-2
Material : SS
Finish : Chrome + Matt
Pivot



DFGP-3
Material : Iron
Finish : Chrome + Matt
Pivot



DFGP-4
Material : SS Brass
Finish : Chrome + Matt
Floor Pivot



DFGP-5
Material : Brass
Brass Centre Pivot



BRACKET SHELF HOLDERS

DORFIX



DFBSH-1
Double Shelf Holder
(10-12mm)



DFBSH-2
Single Shelf Holder
(10-12mm)



DFBSH-3
F-Type Shelf Holder
(6-12mm)



DFBSH-4
Double Shelf Holder
(8-10mm)



DFBSH-5
Single Shelf Holder
(8-10mm)

SHELF BARREL BUTTON

GLASS HINGES (WITH HOLE) (For 5mm-10mm Glass)



DFBSH-5
Double Shelf Barrel Button



DFBSH-6
Single Shelf Barrel Button



DFGH-1
Material : SS (304)
Wall to Glass Hinge



DFGH-2
Material : SS (304)
Glass to Glass Hinge



DFGH-3
Material : Zinc
Wall to Glass Hinge
Heavy Duty



DFGH-4
Material : Zinc
Wall to Glass Hinge
Jumbo



DFGH-5
Material : Brass
Wall to Glass Hinge
Square Deluxe



DFGH-6
Material : Brass
Wall to Glass Hinge
Round Deluxe



DFGH-6 BM
Material : Brass
Wall to Glass Hinge
Round Deluxe



DFGH-6 G
Material : Brass
Wall to Glass Hinge
Round Deluxe



DFGH-6 RG
Material : Brass
Wall to Glass Hinge
Round Deluxe

GLASS HINGES (WITHOUT HOLE) (For 5mm-10mm Glass)



DFGH-7
Material : Brass
Wall to Glass Hinge
Royal



DFGH-8
Material : Brass
Wall to Glass Hinge
Deluxe



DFGH-9
Material : Brass / Zinc
Wall to Glass Hinge
Neelam



DFGH-10
Material : Brass / Zinc
Wall to Glass Hinge
Cobra



DFGH-11
Material : Zinc
Wall to Glass Hinge
Side Hinge



DFGH-12
Material : Zinc
Wall to Glass Hinge
Square



DFGH-13
Material : Brass
Wall to Glass Hinge
Corner



DFGH-13
Material : Brass
Wall to Glass Hinge
Corner



DFGH-13
Material : Brass
Wall to Glass Hinge
Corner



DFGH-13
Material : Brass
Wall to Glass Hinge
Corner



DFGH-14
Material : Brass
Glass to Glass Hinge



Round Cutter

GLASS HOLDERS

GLASS VACCUMS



Two Way Glass Holder



Three Way Glass Holder



Four Way Glass Holder



GLASS RUNNERS



DFGR-1 (Plain)
Material : Iron
Finish : Chrome



DFGR-2 (Cut)
Material : Iron
Finish : Chrome



DFGR-5
Material : SS
Finish : Chrome / Matt



DFGR-3
Material : Iron (Powder Coted)
Finish : Chrome / Teak / Brown



DFGR-4
Material : Iron (Powder Coted)
Finish : Chrome / Teak / Brown

MIRROR & WOODEN SCREWS



DFMS-1 **DFMS-2**



Brass Machine Screw Wooden Screws

OTHER HARDWARE PRODUCTS



DFOH-2
Glass Lock



DFOH-7
Material : Brass / SS
'L' Hinges



DFOH-8
Material : Brass / SS
'W' Hinges

PUSH CATCHER



DFPC-1
Material : Brass
Finish : Chrome + Matt
Push



DFPC-2
Material : Pvc
Finish : Brown / Black
Push



DFPC-3
Material : Pvc (Heavy)
Finish : White
Push



DFGL-1C
Glass Lifter with One Cups



DFGL-2C
Glass Lifter with Two Cups



DFGL-3C
Glass Lifter with Three Cups

GLASS LIFTERS

GLASS CUTTER

NEW!



DFGC-XY-3



DFGC-100



DFGC-999



Glass Bit



DFGC-YGD-4



DFGC-90



DFGC-110



DFGC-111
with Double Head

SPIGOT



DFRA-1
Spigot



DFRA-2
Spigot



DFRA-2A
Spigot



DFRA-2A BM
Spigot



DFRA-2A G
Spigot



DFRA-2A RG
Spigot



DFRA-2B
Spigot



DFRA-2B BM
Spigot



DFRA-2B G
Spigot



DFRA-2B RG
Spigot



DFRA-3
Spigot



DFRA-4
Spigot



DFRA-4A
Spigot



DFRA-4A BM
Spigot



DFRA-4A G
Spigot



DFRA-4A RG
Spigot



DFRA-5
Spigot



DFRA-6
Spigot



DFRA-7
Spigot



DFRA-8
Spigot



DFRA-9
Spigot Mini



DFRA-9 BM
Spigot Mini



DFRA-9 G
Spigot Mini



DFRA-9 RG
Spigot Mini



DFRA-10
Spigot Mini



DFRA-11
Wall to Handrail



DFRA-12
Glass to Handrail



DFRA-12 BM
Glass to Handrail



DFRA-12 G
Glass to Handrail



DFRA-12 RG
Glass to Handrail



DFRA-13
Glass to Handrail



DFRA-14
(Wall to Handrail)
Adjustable



DFRA-14 BM
(Wall to Handrail)
Adjustable



DFRA-14 G
(Wall to Handrail)
Adjustable



DFRA-14 RG
(Wall to Handrail)
Adjustable



DFRA-15
Glass to Handrail



DFRA-16 (Dolphin)
Glass to Handrail



DFRA-17 (Flat)
U Shape
Railing Connector



DFRA-18 (Curve)
U Shape
Railing Connector

STUDS



DFRA-19
Railing Stud 45mm



DFRA-19 BM
Railing Stud 45mm



DFRA-19 G
Railing Stud 45mm



DFRA-19 RG
Railing Stud 45mm



DFRA-20
Railing Stud 25mm



DFRA-20 BM
Railing Stud 25mm



DFRA-20 G
Railing Stud 25mm



DFRA-20 RG
Railing Stud 25mm



DFRA-21
Glass Adjustable Stud



DFRA-21 BM
Glass Adjustable Stud



DFRA-21 G
Glass Adjustable Stud



DFRA-21 RG
Glass Adjustable Stud



DFRA-22
Glass Adjustable Stud



DFRA-22 BM
Glass Adjustable Stud



DFRA-22 G
Glass Adjustable Stud



DFRA-22 RG
Glass Adjustable Stud



DFRA-23
Railing Twin Stud



DFRA-24
Square Railing Stud
(Dia 40x40mm)



DFRA-25
Single Slotted Square Pipe
40x40mm and 60x60mm
Length : 6mtr. (20ft.)



DFRA-25 BM
Single Slotted Square Pipe
40x40mm and 60x60mm
Length : 6mtr. (20ft.)



DFRA-25 G
Single Slotted Square Pipe
40x40mm and 60x60mm
Length : 6mtr. (20ft.)



DFRA-25 RG
Single Slotted Square Pipe
40x40mm and 60x60mm
Length : 6mtr. (20ft.)



DFRA-26
Single Slotted Round Pipe
Ø 38x38mm and 5050mm
Length : 6mtr. (20ft.)



DFRA-26 BM
Single Slotted Round Pipe
Ø 38x38mm and 5050mm
Length : 6mtr. (20ft.)



DFRA-26 G
Single Slotted Round Pipe
Ø 38x38mm and 5050mm
Length : 6mtr. (20ft.)



DFRA-26 RG
Single Slotted Round Pipe
Ø 38x38mm and 5050mm
Length : 6mtr. (20ft.)





GLASS RAILING ACCESSORIES

DORFIX



DFRA-27
Slotted Pipe Jointer 180°



DFRA-28
Round Pipe Jointer 90°



DFRA-29
Round Pipe Jointer L-Type 90°



DFRA-30
Straight Jointer



DFRA-31
Wall to Slotted Pipe Jointer



DFRA-32
Slotted Pipe End Cap



DFRA-33
Sq. Slotted Pipe Jointer 180°



DFRA-34
Sq. Pipe Jointer 90°



DFRA-35
Sq. Pipe Jointer L-Type 90°



DFRA-36
Straight Jointer



DFRA-37
Wall to Slotted Pipe Jointer



DFRA-38
Slotted Pipe End Cap



DFGL-UPR-11
'U' Channel
Size : 25x13x25 and 25x13x35mm
Ythickness 1.6mm
Length : 3.4mtr (11.25ft)



DFGL-UPR-11 BM
'U' Channel
Size : 25x13x25 and 25x13x35mm
Ythickness 1.6mm
Length : 3.4mtr (11.25ft)

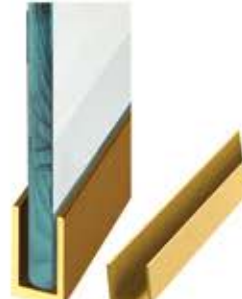

DFGL-UPR-11 G
'U' Channel
Size : 25x13x25 and 25x13x35mm
Ythickness 1.6mm
Length : 3.4mtr (11.25ft)



DFGL-UPR-11 RG
'U' Channel
Size : 25x13x25 and 25x13x35mm
Ythickness 1.6mm
Length : 3.4mtr (11.25ft)

GLAZING PROFILES



DFGL-33
Wall Connecting Profile for Fix Glass
Finish: **Sparkle & Anodised**



DFGL-22
Wall Connecting Profile for Fix Glass
Finish: **Sparkle & Anodised**



DFGL-22 BM
Wall Connecting Profile for Fix Glass



DFGL-22 G
Wall Connecting Profile for Fix Glass



DFGL-22 RG
Wall Connecting Profile for Fix Glass

Material : Nylon

- 1 Set Contain
- Holder (2 Pcs)
- Hinge (1 Pair)
- Indicating Lock (1 Pcs)
- Handle (1 Pair)
- connecting Angle (12 Pcs)
- Hook (1 Pcs)



Holder



Connection Angle



Hook



Hinge



Handle



Indicating Lock



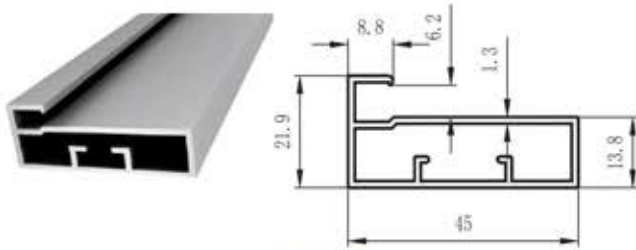

DFWP-1
 Frame Profile 45mm
 Colour : Anodized, CP Finish, Brush CP, SS Brush
 Rose Gold, Black Matt, Gold Matt, Gold Glossy

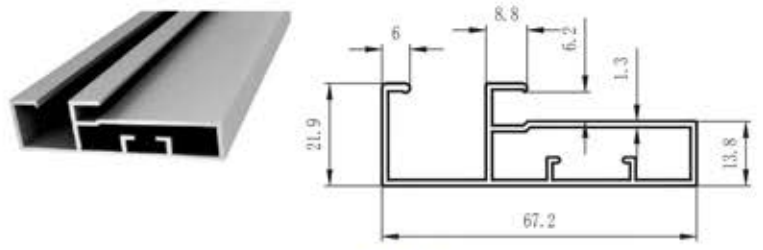

DFWP-2
 Handle Profile for 45mm Frame
 Colour : Anodized, CP Finish, Brush CP, SS Brush
 Rose Gold, Black Matt, Gold Matt, Gold Glossy

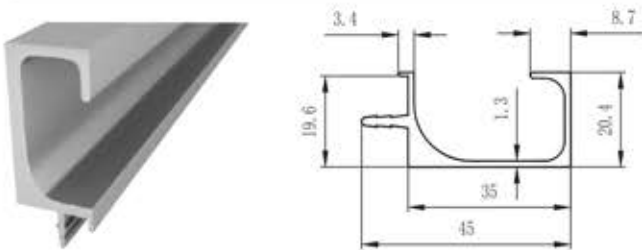

DFWP-3
 G-Wooden Handle Profile
 Colour : Anodized, CP Finish, Brush CP, SS Brush
 Rose Gold, Black Matt, Gold Matt, Gold Glossy

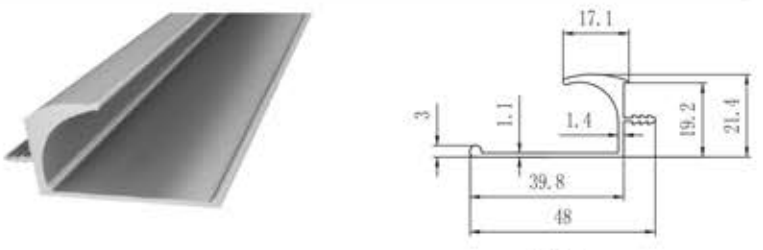

DFWP-4
 K1347
 J-Wooden Handle Profile
 Colour : Anodized, CP Finish, Brush CP, SS Brush
 Rose Gold, Black Matt, Gold Matt, Gold Glossy

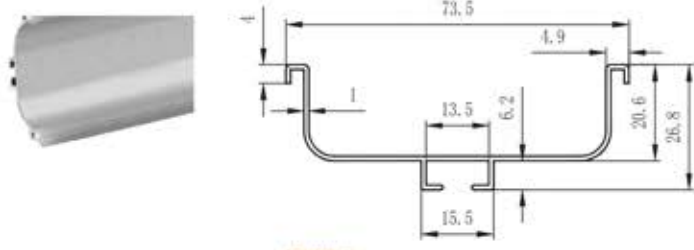

DFWP-5
 C-Profile Gola
 Colour : Anodized, CP Finish, Brush CP, SS Brush
 Rose Gold, Black Matt, Gold Matt, Gold Glossy

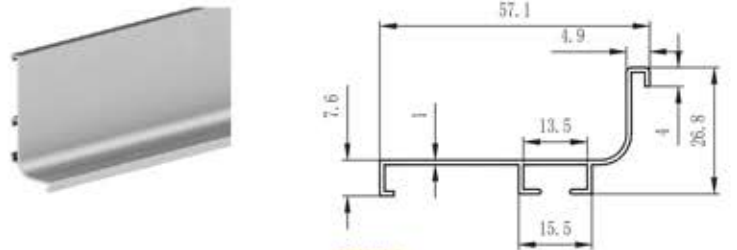

DFWP-6
 J-Profile Gola
 Colour : Anodized, CP Finish, Brush CP, SS Brush
 Rose Gold, Black Matt, Gold Matt, Gold Glossy

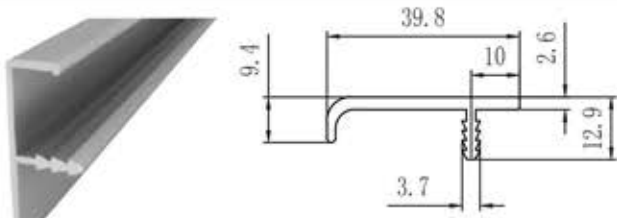

DFWP-7
 MY-A673S
 F-Wooden Handle Profile
 Colour : Anodized, CP Finish, Brush CP, SS Brush
 Rose Gold, Black Matt, Gold Matt, Gold Glossy



DFWP-7
 Aluminium Profile Connectors



DFWP-8
 Aluminium Profile Connectors





ALUMINIUM RAILING

ALUMINIUM RAILING - HAND RAIL

Available Colours :
 Grey Black Matt Champagne Walnut Wood



DFRH-1 (50X50)
Single Groove Round Pipe
Aluminium Hand Rail



DFRH-1 A
Wall Concealed



DFRH-1 B
End Cap



DFRH-1 C
Corner Connector



DFRH-1 D
Straight Connector



DFRH-2 (40X40)
Single Groove Square Pipe
Aluminium Hand Rail

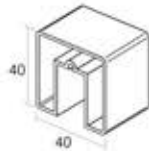

DFRH-2 A
Wall Concealed



DFRH-2 B
End Cap



DFRH-2 C
Corner Connector



DFRH-2 D
Straight Connector



DFRH-3 (50X50)
Single Groove Square Pipe
Aluminium Hand Rail

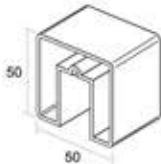

DFRH-3 A
Wall Concealed



DFRH-3 B
End Cap



DFRH-3 C
Corner Connector



DFRH-3 D
Straight Connector



DFRH-5 (45X65)
Single Groove Rectangle Pipe (Top Curve)
Aluminium Hand Rail



DFRH-5 A
Wall Concealed



DFRH-5 B
End Cap



DFRH-5 C
Corner Connector

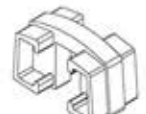

DFRH-5 D
Straight Connector



DFRH-6 (20X25)
Single Groove Pipe
Aluminium Hand Rail

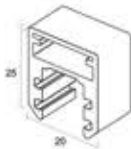

DFRH-6 A
Wall Concealed



DFRH-6 B
End Cap



DFRH-6 C
Corner Connector



DFRH-6 D
Straight Connector



DFRH-4 (38.5X84)
Single Groove Rectangle Pipe (Top Curve)
Aluminium Hand Rail

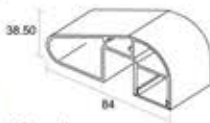

DFRH-4 A
Wall Concealed



DFRH-4 B
End Cap



DFRH-4 C
Corner Connector



DFRH-4 D
Straight Connector



DFRH-7 (71X35)
LED- Aluminium Hand Rail

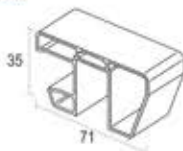

DFRH-7 A
Wall Concealed



DFRH-7 B
End Cap



DFRH-7 C
Corner Connector



DFRH-7 D
Straight Connector

ALUMINIUM RAILING -BASE RAIL

Available Colours :
 Grey Black Matt Champagne Walnut Wood



DFRB-1
Aluminium Base Rail **DFRB-1**
Cover



DFRB-2
Aluminium Base Rail **DFRB-2**
Cover



DFRB-3
Aluminium Base Rail **DFRB-3**
Cover



DFRB-4
Aluminium Base Rail **DFRB-4**
Cover



DFRB-5
Aluminium Base Rail **DFRB-5**
Cover

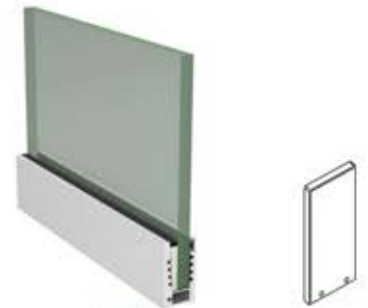

DFRB-6
Aluminium Base Rail **DFRB-6**
Cover



DFRB-7
Aluminium Base Rail **DFRB-7**
Cover



DFRB-8
Aluminium Base Rail **DFRB-8**
Cover



DFRB-9
Aluminium Base Rail



EXCELLENT SEAL

EXCELLENT BONDING

EXCELLENT WEATHERABILITY



Neutral Weatherproof Silicone Sealant

Characteristics:

- Highly elastic and excellent unpermed adhesion to most building excellent materials.
- Long use life, with high resistance to ultraviolet radiation, rainfall, heat and humidity.
- Excellent resistance against temperature extremes, remains flexible within temperature range of -40°C to +100°C
- One part with outstanding weatherability and resistance to again

Major Uses:

- Weatherproof sealing of glass curtain wall.
- Weatherproofing sealing of various metals, aluminum curtain walls and building facades.
- Joint seal of other concrete or plastic constructions.
- A variety of other building and industria uses.

Storage Shelf Life:

Kliff 789 weatherproof silicone sealant should be stored in cool and dry places over the temperature from 0°C to 27°C, under which the shelf life is 12 months from the date of production

Limitations:

- Not suitable for confined or non-ventilated places as weatherproof sealant requires atmospheric moisture to cure.
- Not suitable for wet/frosty surfaces.
- Do not apply with the surfaces that needs to be painted or have continuous contact with water
- Do not apply with the material having surface temperature not between 5°C to 50°C.



General Purpose Silicone Sealant

Characteristics:

- Easy to use, one-part sealant cured quickly, good weather ability.
- One-componet acetic cured, no mixing required.
- Adhesive to metals, glass, glazed, plastic, paint coated surfaces and many building materials.
- Excellent UV, ozone and chemical resistance, unattached by sunlight, rain, snow and temperature extremes

Major Uses:

- For joint filling and window sealing
- For sealing doors glass-related buildings
- For non-oily wood, coated surfaces Aluminum alloy and ceramic tiles etc.

Storage Shelf Life:

Kliff GP should be stored in cool and dry places over the temperature from 0°C to 27°C, under which the shelf life is 12 months from the date of production

Limitations:

- Do not use for curtain wall structural glazing.
- Not suitable for confined or non-ventilated places as it requires atmospheric moisture to cure.
- Not suitable for wet/frosty surfaces.
- Do not apply with the surfaces that needs to be painted or have continuous contact with water
- Do not apply with the material having surface temperature not between 5°C to 50°C.

SILICON GUN



Silicon Gun



Silicon Gun (Heavy)

ADHESIVE



UV Adhesive



UV Adhesive



UV Light

GLAZING TAPE * Customized size available according to specific order.



Special Feature

Easy to assemble, no drilling, riveting, welding or screw fastening.
 Excellent seal against water, moisture and dust.
 Quick and easy to apply, saves time, labour costs and greater bonding strength.
 Ideal for bonding to a variety of substrates like most metals, glass, plastics, composites and painted surface.

Glazing Double Side Tape

- * Durable, high performance two-sided pressure sensitive acrylic foam tapes.
- * A high strength, clear, UV resistant double-sided film.
- * Has high adhesion and shear strength.
- * Heat and solvent resistant.
- * A good general purpose, permanent glazing tape.

Applications:

- * Bonding glass to metal frames (aluminium panel) in curtain wall systems and commercial windows
- * Attachment of stiffeners and perimeter clips to architectural panels
- * Exterior building cladding



ADHESIVE	Acrylic
ADHESIVE CARRIER	Acrylic Foam
THICKNESS	1.2mm & 2.0 mm
TAPE COLOR	Grey
LINER	Red PE Film
PACKING	100 rolls per cartoon

Our Presence in India



- 📍 Andhra Pradesh
- 📍 Bihar
- 📍 Chandigarh
- 📍 Chhattisgarh
- 📍 Delhi
- 📍 Goa
- 📍 Gujarat
- 📍 Haryana
- 📍 Himachal Pradesh
- 📍 Jammu & Kashmir
- 📍 Jharkhand
- 📍 Karnatka
- 📍 Kerala
- 📍 Ladakh
- 📍 Madhya Pradesh
- 📍 Maharshra
- 📍 Punjab
- 📍 Rajasthan
- 📍 Tamilnadu
- 📍 Telangana
- 📍 Uttar Pradesh
- 📍 Uttarakhand
- 📍 West Bengal

Download Dorfix
App from



Authorized Channel Partner



Head Office

PLOT NO. 20, STREET NO. 1, SHAHBAD
EXTENSION, ROHINI SECTOR 17, NEW DELHI-110089

✉️ dorfixhardware@gmail.com 🌐 www.dorfixhardware.com

Scan QR Code
for website